



Vichnet Wire Mesh Cable Tray

NINGBO VICHNET TECHNOLOGY CO., LTD

www.vichnet.com

ICONS

ICONS DESCRIPTION



New Product



ALL refers to stainless steel materials 304/316/316L and carbon steel processed by electrogalvanizing, hot-dip galvanizing, nickel coating or powder coating.



Accessories in common use



Recommended



Bare/ungalvanized



An eco-friendly material that emits low smoke and zero halogen when exposed to high sources of heat. Recommended for indoor use.



Specifically designed and engineered to brace and secure suspended non-structural equipment and components within a building or structure to minimize damage from an earthquake or seismic event. Suitable for HVAC duct, conduit/cable tray, and piping.



Steel, electrogalvanized according to ISO 2081. Recommended for indoor use.



Steel, hot dip galvanized according to ISO 1461. Recommended for indoor or outdoor use.



Steel, Dacromet coated. The zinc- and aluminum-flake coating is appropriate for high corrosion demands. Recommended for indoor and outdoor use.



Steel, powder coated according to ISO 14922. Recommended for indoor use.



Steel, nickel plated. The corrosion-resistant, ecofriendly, and cost-efficient finishing effectively prevents the formation of zinc whiskers. Recommended for indoor and outdoor use, especially recommended for use in data centers.



Steel, zinc-nickel plated. It's safe, corrosion-resistant, environmentally friendly, and aesthetical. Recommended for indoor and outdoor use, especially for the corrosive environment.



Steel, pre-galvanized according to EN 10346. Recommended for indoor use.



Stainless Steel SS304, recommended for indoor or outdoor use, commonly used in food and tobacco industries.

ICONS

ICONS DESCRIPTION

S316

Stainless Steel SS316, recommended for indoor or outdoor use, commonly for aggressive environments.

S316

Stainless Steel SS316, recommended for indoor or outdoor use, commonly for aggressive environments.

S316L

Stainless Steel SS316L, recommended for indoor or outdoor use, commonly for high aggressive environments, such as marine environments.

Pvc

Polyvinyl chloride, FV-0 flammability (equals to UL94-V0), commonly used for the straight sections of fiber cable trays.

ABS

Acrylonitrile butadiene styrene, FV-0 flammability (equals to UL94-V0), commonly used for the accessories of fiber cable trays.

AL

Aluminum, commonly used for ladder cable trays, solid-bottom cable trays or perforated cable trays.

CONTENTS

GENERAL INFORMATION

| Company Profile

| Certificates

GI

| Material & Finish

| Performance Specification

| Corrosion

| Installation Instructions

| Warning

WIRE MESH CABLE TRAY SYSTEM

| CM Series Customized
Welding Elbow

| CM Special Series

| TCM Self-lock Series

| Accessories

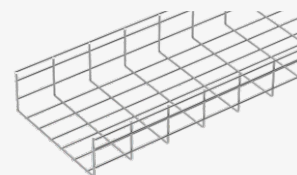



GENERAL INFORMATION

■ Company Profile

■ Material & Finish

■ Corrosion

■ Warning

■ Certificates

■ Performance Specification

■ Installation Instructions

CONTENTS OF GENERAL INFORMATION

Company Profile -----	006
Certificates -----	008
Material & Finish -----	009
Carbon Steel	
Electrogalvanized	
Hot Dip Galvanized	
Pre-Galvanized	
Nickel Plated	
Zinc-Nickel Plated	
Powder Coated	
Stainless Steel	
Aluminum	
PVC and ABS	
Performance Specification -----	013
Cable Tray Specification in Common Use	
Safe Working Load Data	
Corrosion -----	014
Atmospheric Corrosion	
Chemical Corrosion	
Storage Corrosion	
Galvanic Corrosion	
Installation Instructions -----	015
Support Span	
Support Installation	
Straight Section Position	
Field Modifications	
Barrier Requirements	
Future Expansion Requirements	
Warning -----	017

COMPANY PROFILE



Established in 2006, Ningbo Vichnet Technology Co., Ltd is committed to the development, manufacturing, and sales of intelligent safety protection systems. Our cable trays have smooth solder joints, high loading capacities, and are available in a wide variety of product specifications. Our chamfered angle designs effectively prevent cable damage, and the open structure of our wire mesh cable tray products prevent pest infection, mold, and corrosion. Wire mesh cable trays are easy to clean, allow for good heat dissipation, and simplify maintenance and repair procedures. Our products can be flexibly adapted to a wide variety of industrial situations.

Our cable management systems are used in data centers by companies like Alibaba, Huawei, Tencent, Google, on automobile manufacturing lines by companies like Ford, General Motors, Geely, in food manufacturing plants by companies like Budweiser, Wahaha, Evergrande Group, in power plants by companies like Siemens and in cruise ships. Our products are sold to clients from more than 100 countries and regions.

Our manufacturing plant is equipped with fully automated machinery, and complete quality assurance systems. We have obtained the ISO9001 quality management certification, the ISO14001 environmental management certification, the ISO45001 occupational health and safety management certification, and fire safety certifications. Our products have received CE, UL, CUL, and E90 certifications.

As a leading player in China's cable tray industry, Vichnet has participated in formulating a number of national standards for warehouse logistics, food machinery, and communication engineering. We hold more than 100 patents and we have successfully industrialized numerous proprietary technologies, such as nanofilm metal finishing that prevents zinc-whisker formation, intelligent safety system development, and metal mesh protective gear manufacturing technologies.





CERTIFICATES



UL



CE



E90 Fire Rating



ISO9001

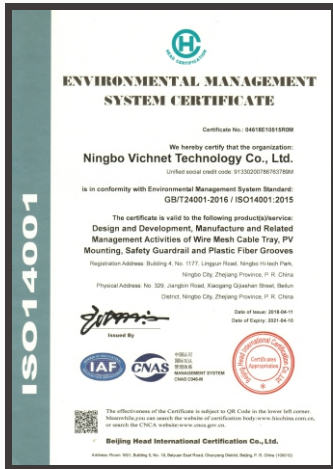

ISO14001



ISO45001

Product Certificates

- UL
- CUL
- CE
- E90 Fire Rating
- TÜV
- SGS

Management System Certificates

- ISO9001 Quality Management System Certificate
- ISO14001 Environmental Management System Certificate
- ISO45001 Occupational Health and Safety Management System Certificate

MATERIAL & FINISH

Table 1 Recommended Operating Environment

Environment Material	Indoor and Dry	Low Corrosivity (Class 0)	Medium Corrosivity (Class 1)	High Corrosivity (Class 2)	Data Center (ISO14644-1 Standards)
EZ Electrogalvanized	√	—	×	×	×
Hdg Hot Dip Galvanized	—	√	—	×	√
Dac Dacromet	—	√	—	×	√
GI Pre-Galvanized	—	×	×	×	×
PC Powder Coated	√	—	×	×	√
Ni Nickel Plated	√	√	√	×	√
Nizn Zinc-Nickel Plated	√	√	√	×	√
S304 SS304	√	√	√	×	√
S316 SS316	√	√	√	×	√
S316L SS316L	√	√	√	√	√
AL Aluminum	√	×	×	×	√
Pvc PVC	√	×	×	×	√
ABs ABS	√	×	×	×	√
BL Ungalvanized	×	×	×	×	×

Remark

- (1) √Recommended, - Available, ×Not Recommended.
- (2) Zinc whiskers produced by electro-galvanizing can cause short circuit in the equipment, so electro-galvanizing should not be used in data centers.
- (3) In data center environments, powder coating can be used on stainless steel, nickel-plated steel, or hot-dip galvanized steel, but should not be used directly on electrogalvanized or pre-galvanized steel products.
- (4) Refer to Table 2 for corrosivity categories.

BL Carbon Steel

Steel cable trays are fabricated from continuous roll-formed high quality carbon steel so that their mechanical properties are enhanced, allowing for the use of a lighter gauge steel to carry the required load. This reduces the dead weight that must be carried by the supports and makes the system easier to install for the contractor. By using high quality carbon steel, Vichnet ensures that the material will meet the minimum yield and tensile strengths required by national standards.

EZ Electrogalvanized

Electrogalvanization is the process by which a coating of zinc is deposited on the steel by electrolysis to form a tough, adherent and protective film. This film itself is a barrier coating which slows subsequent corrosive attack on the zinc. This coating is usually only recommended for indoor use in relatively dry areas, as it provides limited protection (ninety-six hours of protection in salt spray).

Hdg Hot Dip Galvanized

Hot dip galvanizing is an effective way to protect steel against corrosion, It is commonly used for wire mesh cable trays, channel cable trays and ladder cable trays, etc. Cable trays are completely immersed in a bath of molten zinc. A metallic bond occurs resulting in a zinc coating that completely coats the products surface to provide protection against corrosion.

Hot dip galvanizing is recommended for prolonged outdoor exposure and will protect steel for many years in most outdoor environments as well as in many aggressive industrial environments.

GI Pre-Galvanized

Pre-galvanized steel is produced by unwinding steel coil and passing it continuously through a bath of molten zinc and then past air jets to remove excess zinc from the surface. The process is closely controlled to produce a thin, even and ripple free zinc coating with very few imperfections.

Because this pre-galvanized steel coil must be cut to shape during subsequent manufacturing processes, the edges of the finished products will have no zinc coating. This aspect, together with the relatively light zinc coating provided by the process, make pre-galvanized products suitable for indoor, low-corrosive environments, but unsuitable for humid indoor or outdoor applications.

Ni Nickel Plated

Nickel plating is a proprietary metal finishing technology developed by Vichnet. Nickel plating provides a safe, cost-effective, ecofriendly, abrasion resistant, and corrosion resistant alternative to traditional zinc galvanizing. Nickel plating is particularly suited for data center environments where zinc whiskers pose safety hazards. Vichnet nickel-plated cable trays are manufactured using metal alloy nanofilm formation technology (Vichnet patent), which creates dense, even, and strongly bonded nanometal or alloy films through oxidation-reduction reactions. Recommended for indoor and outdoor use, especially recommended for use in data centers.

Nizn Zinc-Nickel Plated

Zinc-nickel plating is combined with a main protective layer (nickel plating), a sacrificial protective layer (zinc coating) and an outer protective layer (polymer nanofilm). It's safe, corrosion-resistant, environmentally friendly, and aesthetical.

PC Powder Coated

Powder coating may be applied as a protective finish but more generally it is requested as a decorative layer applied to systems already protected by a zinc coating to meet the requirement of color management in modern cable supporting systems.

S304 S316 S316L Stainless Steel

Stainless steel contains a high proportion of chromium (usually at least 11%) and the steel's remarkable immunity to corrosive attack is conferred by the chromium-rich oxide film which occurs naturally on its surface. For most practical purposes stainless steel can be regarded as maintenance free and suffering no corrosion.

The regular grades of stainless steel to be used for cable trays are SS304, SS316, SS316L. Users can choose what they need according to their application environment, anti-corrosion requirement and budget, etc.

AL Aluminum

Aluminum cable trays are widely used because of their high strength-to-weight ratio, excellent resistance to certain corrosive environments, and easy installation. Aluminum has exceptional corrosion resistance, including weather resistance, which is attributed to its self-healing and protective surface aluminum oxide film. The aluminum cable tray also has the advantages of being light weight (about 50% of the weight of the steel cable tray) and maintenance-free. In addition, because the aluminum alloy cable tray is non-magnetic, it can minimize electrical loss.

Pvc Abs PVC and ABS

Compared with steel cable tray, plastic cable tray has the features of being light weight and having great atmospheric corrosion resistance. Vichnet fiber cable trays and their covers are made from PVC, and the accessories are made from ABS. Both PVC and ABS are flame retardant rated FV-0 which equals to UL94-V0.

Table 2 Corrosivity Categories

Reference		Category			
		Indoor and Dry	Low Corrosivity (Class 0)	Medium Corrosivity (Class 1)	High Corrosivity (Class 2)
Main Features of Chemical Corrosion	Operating Conditions	The chemicals can be smelled sometimes.	Due to the wind direction, the chemicals can be smelled sometimes.	The irritation of chemicals can often be felt, but normal process operations can be performed without wearing protective gear.	Strong irritation to eyes or external respiratory tract, sometimes it is necessary to perform normal process operations wearing protective gear.
	Phenomena	The corrosivity is very low. Buildings, and facilities have only general rust and corrosion. Process and electrical facilities only need regular maintenance.	Buildings and facilities have only general rust and corrosion. Process and electrical facilities only need regular maintenance. Generally, trees grow normally.	The corrosion of buildings and facilities is obvious. Process and electrical facilities generally require annual overhaul. Generally, trees do not grow well.	The corrosion of buildings and facilities is serious. The interval of equipment overhaul is relatively short. Generally, trees grow shorter.
Ventilation		Normal ventilation conditions	Normal ventilation conditions	Good natural ventilation	Poor ventilation
Installation Sites		Dry and clean indoor site	Inland, far from chemically corrosive substances	Some distance from the seashore, or in places where the concentration of chemically corrosive substances is relatively low	Seashore or places with strong chemically corrosive substances
Humidity and Temperature Characteristics		Low relative humidity	Short durations of high relative humidity	Medium duration of relative humidity	Hot and humid areas with long-term high relative humidity

PERFORMANCE SPECIFICATION

Cable Tray Specifications in Common Use						
Height Width	25	50	75	100	150	200
50	△	△	△	△	△	△
100	△	△				
200	△	△	△			
300	△	△	△	△		
400		△	△	△	△	
500			△	△	△	△
600			△	△	△	△
800			△	△	△	△
1000				△	△	△
1200					△	△

Remark: △ means the specification in common use

Safe Working Load Data					
Wire Diameter 5.0mm		SWL Data (kg/m)			
		Support Interval			
Height (mm)	Width (mm)	1.0m	1.5m	2.0m	3.0m
50	50	91	70	47	23
	100	99	76	51	25
	150	103	79	53	26
100	100	143	110	73	37
	200	159	122	81	41
	300	183	141	94	47
150	200	257	198	132	66
	300	273	240	140	70
	400	285	219	146	73

Remark: The actual maximum load data is twice or three times of SWL data.

CORROSION



Atmospheric Corrosion

Atmospheric corrosion occurs when metal is exposed to airborne liquids, solids or gases. Some causes of atmospheric corrosion are moisture, salt, dirt and sulfuric acid. This form of corrosion is typically worse outdoors, especially near marine environments.

Chemical Corrosion

Chemical corrosion takes place when metal comes in direct contact with a corrosive solution. Some factors which affect the severity of chemical corrosion include: chemical concentration level, duration of contact, frequency of washing, and operating temperature.

Storage Corrosion

Wet storage stain (white rust) is caused by the entrapment of moisture between the surfaces of closely packed and poorly ventilated materials for an extended period of time. Wet storage stain is usually superficial, having no effect on the properties of the metal. Light staining normally disappears with weathering. Medium to heavy buildup should be removed, in order to allow the formation of the normal protective film.

Proper handling and storage will help to ensure stain-free materials. If product arrives wet, it should be unpacked and dried before storage. Dry materials should be stored in a well ventilated low moisture environment to avoid condensation. Outdoor storage is undesirable and should be avoided whenever possible.

Galvanic Corrosion

Galvanic corrosion occurs when two or more dissimilar metals are in contact while in the presence of an electrolyte (i.e. moisture).

It is very important to consider the effects of electrolytic corrosion when selecting the assembly hardware. Ideally, the finish of the cable tray and hardware should be identical. But if this is not possible, the relatively small hardware should always be higher grade than the large volume tray, e.g. use stainless steel bolts for hot dip galvanized tray but not the other way round.

INSTALLATION INSTRUCTIONS



Cable management system designs should comply with national standards. It is recommended that installation work is performed by qualified personnel, preferably a certified electrical contractor familiar with standard electrical construction practices, electrical equipment, and the safety of electrical wiring systems.

Support Span

The strength of a cable tray system is largely determined by the strength of its side rails. The strength of a cable tray side rail is reversely proportionate to the distance between the supports on which it is installed, commonly referred to as the "support span". Therefore, the strength of a cable tray system can be altered by changing the support span. However, there is a limit to how much that strength can be increased by reducing the support span. Once the load requirement has been determined, the following factors should be considered:

- (1) Sometimes the location of existing structural beams will dictate the cable tray support span. This is typical with outdoor installations where adding intermediate supports could be financially prohibitive. For this situation the appropriate cable tray must be selected to accommodate the existing span.
- (2) When cable tray supports are randomly located, the added cost of a higher strength cable tray system should be compared to the cost of additional supports.
- (3) The support span lengths should be equal to or less than unspliced straight section lengths, to ensure that no more than one splice is placed between supports.

Support Installation

Supports for cable trays should provide strength and working load capabilities sufficient to meet the load requirement of the cable tray wiring system. Consideration should be given to the loads associated with future cable additions or any other additional loads applied to the cable tray system or the cable tray support system.

Straight Section Position

After the supports are in place, the installation of the cable tray can begin at any place that is convenient. It is not necessary to start at one end of the run. It is ideal to lay out the system so that splice joints fall between the support and the quarter point. This maximizes the rigidity of the cable tray.

Field Modifications

Cable Tray can be adapted (cut to spec in field situations). These field modifications should be made by qualified personnel only (preferably a certified electrical contractor).

Barrier Requirements

Barrier strips are used to separate cable systems. The barriers should be made of the same material type as the cable tray. When ordering the barrier, the height must match the loading depth of the cable tray into which it is being installed.

Future Expansion Requirements

One of the many features of cable trays is the ease of adding cables to an existing system. Future expansion should always be considered when selecting a cable tray, and allowance should be made for additional fill area and load capacity. A minimum of 50% expansion allowance is recommended.

WARNING



Cable trays should not be used as a walkway, ladder, or support for people; cable trays are mechanical support system for cables and raceways.

Using cable trays as a walkway can result in personal injury and also cause damage to the cable tray system and installed cables.

Hazardous voltages in electrical equipment can cause severe personal injury or death.

Safety related work practices, as described in national regulations should be followed at all times. The overall performance of a cable tray wiring system is dependent upon proper installation, including the proper installation of supports and cables. Non-adherence to installation and maintenance guidelines may lead to personal injury as well as damage to property.

Installation and proper maintenance of cable tray wiring systems should be performed only by qualified personnel.

(1) A qualified installer is one who is familiar with electrical construction. In addition, the person should be: Trained and authorized to test, energize, clear, ground, tag, and lockout circuits in accordance with established safety practices.

(2) Trained in the proper care and use of protective equipment such as insulated rubber gloves, hardhats, safety glasses or face shields, dust masks and flash resistant clothing in accordance with established safety practices and/or local building codes.



Storage

Aluminum, Fiberglass, Stainless Steel and/or other non-metallic cable trays can be stored outside without protective covering.

Trays should be loosely stacked, elevated off the ground, and ventilated to prevent storage stain. If appearance is important, cable trays should be stored indoors to prevent water or other environmental factors from staining or adhering to cable trays.

Hot dipped galvanized, pre-galvanized or electrogalvanized cable trays must be protected or stored in a well ventilated, dry location.

PVC or powder coated cable trays should be protected and stored indoors if possible.

Cable trays must be protected from scratching and marring of finish.



- Setter of Wire Mesh Cable Tray Standards for the Communication Industry
- Customizable Cable Tray Elbows
- Inventor of Industry-changing Eco-friendly Nickel Plating Technology



WIRE MESH CABLE TRAY SYSTEM

■ **CM Series**

■ **TCM Self-lock Series**

■ **CM Special Series**

■ **Accessories**

WIRE MESH CABLE TRAY SYSTEM



- The weight of wire mesh cable trays are 1/5 of traditional cable trays, making them easier to install.
- The open design allows continuous airflow, which prevents overheating and the build-up of dust and contaminants.
- All kinds of elbows can be made at the project site flexibly.
- Multiple finishes are available for indoor and outdoor applications.
- Cable visibility allows for more convenient upgrading and maintenance.

Wire Mesh Cable Tray Contents

Product Description

Part Number

SYSTEM-----027

CM50 Series	CM50
CM100 Series	CM100
CM150 Series	CM150
CM33 Special Series	CM33x33
CMS50 Special Series	CMS50x50
TCM Self-lock Series	TCW-W

ACCESSORIES-----031

常 Self-Locking Cover	PJ-RCVR
常 Divider	PJ-DVR
常 Reinforced Divider	PJ-HJDVR
常 KKY Coupler	PJ-KKY-SET
常 KK34 Coupler	PJ-KK34-SET
常 KK28 Coupler	PJ-KK28-SET
常 Strengthening Bar	PJ-SBR-SET
常 Corner Strengthening Bar	PJ-CSB-SET
常 Radian Connector	PJ-RC90-SET
常 Adjustable Connector	PJ-AJC-SET
常 Cable Drop-Out	PJ-CGD
常 Cap	PJ-CAP
常 Earthing Bolt	PJ-EHB
常 Signage	PJ-SGN
常 Terminator	PJ-TTR
常 Spider Bracket	PJ-SPB
常 Wire Cutter	GBJ-CUT
Cover	PJ-CVRC
Fast Lock	PJ-FLK
Industrial Mount Bracket	PJ-LJQD
Tube Outlet	PJ-CDH

CEILING BRACKET -----042

常 Trapeze Bar	PJ-BR
常 Strut Channel Bar with KSK	PJ-UHDC
常 Hold Down Clip Set	PJ-HDC
常 Fast Channel Clip	PJ-KSK
常 Threaded Rod	TY-ROD
常 Drop In Anchor Bolt	TY-PANR
常 Flange Nut	TY-FNUT
常 Rod Cap	TY-RODCAP
常 Strut Channel Terminator	PJ-CCT
M Shaped Bar	PJ-MBR
Hanging Hook	PJ-HKS
50 Tray Holder	PJ-THR
Flag Type Hanging Bracket	PJ-RFB
Clip for I-Beam	PJ-CIB
T-Type Hanging Bracket	PJ-THB

WALL BRACKET -----050

常 L-Type Wall Bracket	PJ-LWB
常 Cantilever Wall Bracket	PJ-CWB
常 Strut Channel Wall Bracket	PJ-TWH
常 T-Type Wall Bracket	PJ-CRP
常 T-Type Wall Holder	PJ-TWH
常 Spider Bracket	PJ-SPB
Concrete Wedge Anchor Bolt	TY-CANR

FLOOR STAND -----054

常 Cabinet Top Stand	PJ-EFS
常 Underfloor Bracket	PJ-UFB
常 Bridge Type Stand	PJ-BTS
常 50 Side Floor Bracket	PJ-FSDB
常 Spider Bracket	PJ-SPB
常 Trapeze Bar	PJ-BR
50 Floor Stand	PJ-50FSD
100 Floor Stand	PJ-100FSD
Flag Type Floor Stand	PJ-FFS

OTHERS -----059

常 Wall Mount Coupler	PJ-CDKK
常 Central Hold Down	PJ-CHD
常 Wire Clip	PJ-DSKK
常 Mounting Clip	PJ-SHD
常 Cross Clip	PJ-CCP

Wire Mesh Cable Tray Installation

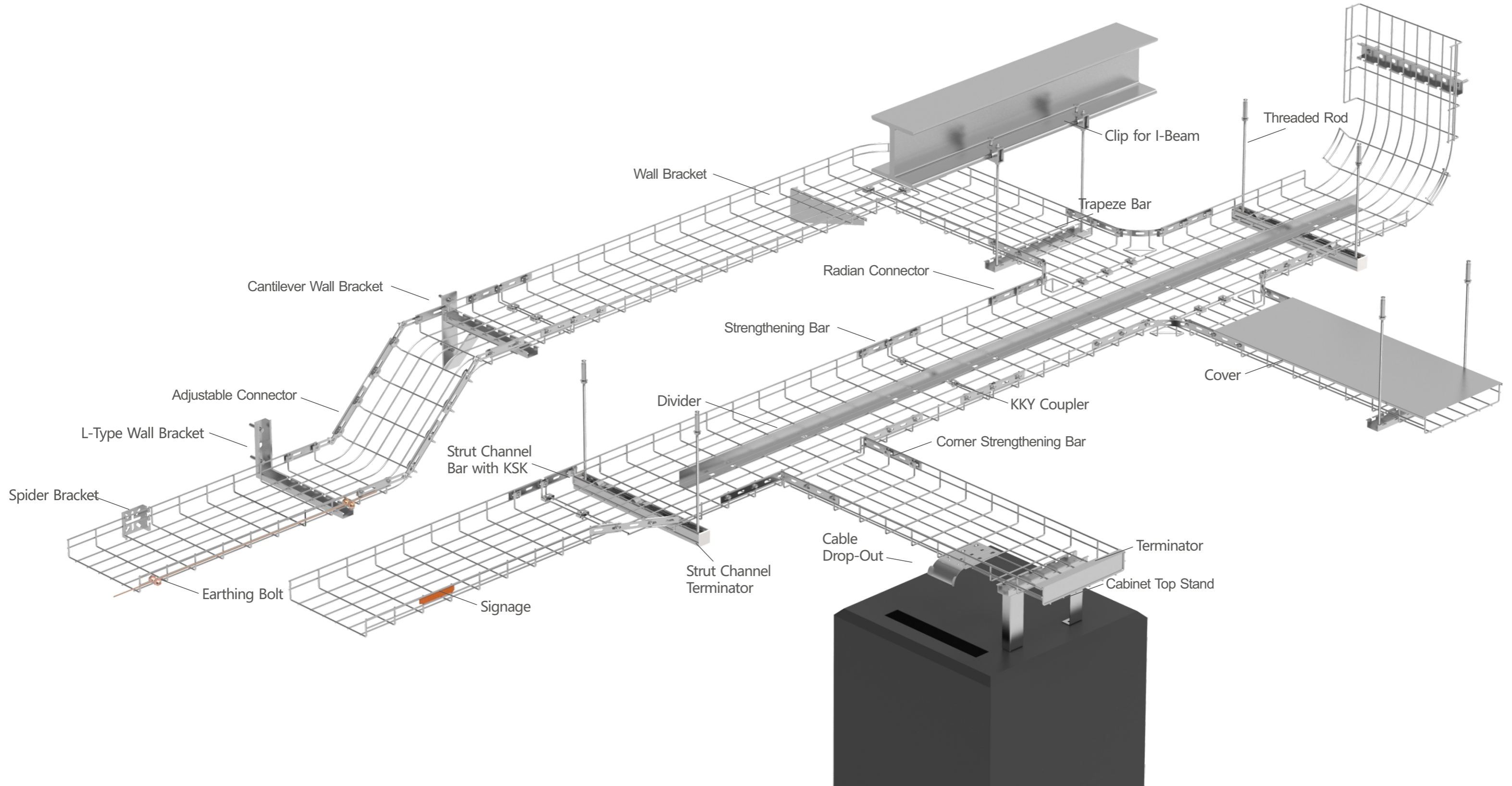

CM50 SERIES

Default unit: mm

Part Number	Height	Width	Length	Wire Diameter	Weight
ALL CM50x50	50	50	3000	5.0	3.15kg
ALL CM50x100	50	100	3000	5.0	3.84kg
ALL CM50x150	50	150	3000	5.0	4.56kg
ALL CM50x200	50	200	3000	5.0	5.25kg
ALL CM50x300	50	300	3000	5.0	6.66kg
ALL CM50x400	50	400	3000	5.0	8.07kg
ALL CM50x450	50	450	3000	5.0	8.76kg
ALL CM50x500	50	500	3000	5.0	9.48kg
ALL CM50x600	50	600	3000	5.0	10.89kg

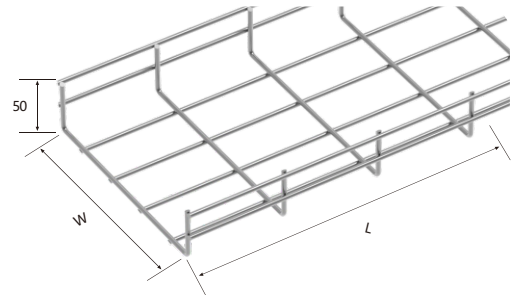
P/N Definition:

- ◆ E.g. CM50x50, CM means wire mesh cable tray, 50x50 means HxW (inner size).
- ◆ Wire diameter range: 3.5mm-6.0mm (common diameter 5.0mm).

Sectional View and Load Chart

Size	Section
50x50	
50x100	
50x150	
50x200	
50x300	
50x400	
50x450	
50x500	
50x600	

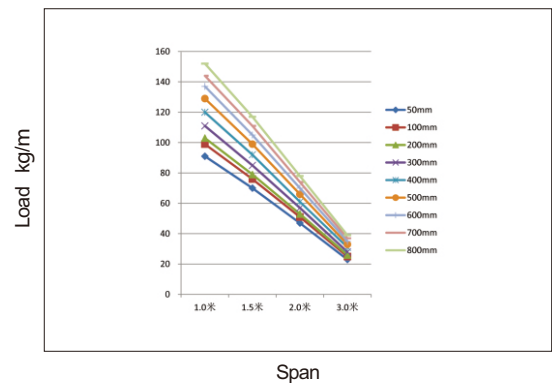

CM100 SERIES

Default unit: mm

Part Number	Height	Width	Length	Wire Diameter	Weight
ALL CM100x100	100	100	3000	5.0	5.25kg
ALL CM100x150	100	150	3000	5.0	5.94kg
ALL CM100x200	100	200	3000	5.0	6.66kg
ALL CM100x300	100	300	3000	5.0	8.07kg
ALL CM100x400	100	400	3000	5.0	9.48kg
ALL CM100x450	100	450	3000	5.0	10.17kg
ALL CM100x500	100	500	3000	5.0	10.89kg
ALL CM100x600	100	600	3000	5.0	12.30kg

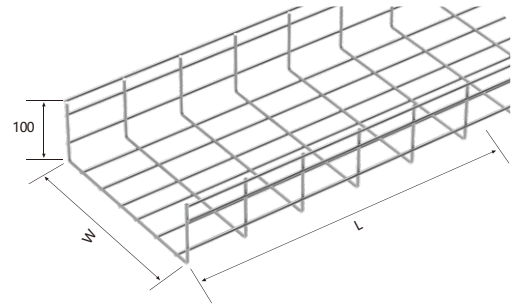

P/N Definition:

- ◆ E.g. CM100x100, CM means wire mesh cable tray, 100x100 means HxW (inner size).
- ◆ Wire diameter range: 3.5mm-6.0mm (common diameter 5.0mm).

Sectional View and Load Chart

Size	Section
100x100	
100x150	
100x200	
100x300	
100x400	
100x450	
100x500	
100x600	

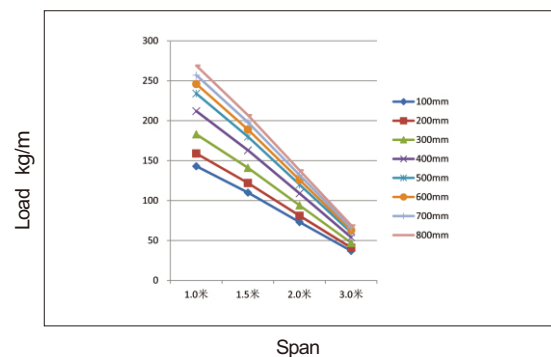

CM150 SERIES

Default unit: mm

Part Number	Height	Width	Length	Wire Diameter	Weight
ALL CM150x150	150	150	3000	5.0	7.35kg
ALL CM150x200	150	200	3000	5.0	8.07kg
ALL CM150x300	150	300	3000	5.0	9.48kg
ALL CM150x400	150	400	3000	5.0	10.89kg
ALL CM150x450	150	450	3000	5.0	11.58kg
ALL CM150x500	150	500	3000	5.0	12.30kg
ALL CM150x600	150	600	3000	5.0	13.71kg

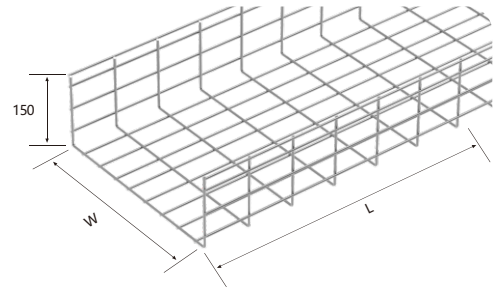
P/N Definition:

- ◆ E.g. CM150x150, CM means wire mesh cable tray, 150x150 means HxW (inner size).
- ◆ Wire diameter range: 3.5mm-6.0mm (common diameter 5.0mm).

Sectional View and Load Chart

Size	Section
150x150	
150x200	
150x300	
150x400	
150x450	
150x500	
150x600	

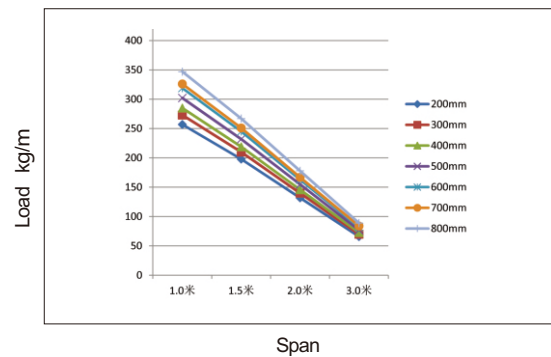

CM33 SPECIAL SERIES

Default unit: mm

Part Number	Height	Width	Length	Wire Diameter	Weight
ALL CM33x33	33	33	3000	5.0	2.43kg

P/N Definition:

- ◆ E.g. CM33x33, CM means wire mesh cable tray, 33x33 means HxW (inner size).
- ◆ Wire diameter range: 3.5mm-6.0mm (common diameter 5.0mm).
- ◆ CM33 series is generally applied to machanical equipment.

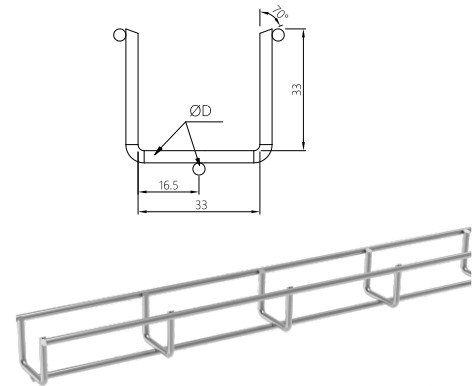

CMS50 SPECIAL SERIES

Default unit: mm

Part Number	Height	Width	Length	Wire Diameter	Weight
ALL CMS50x50	50	50	3000	5.0	3.84kg

P/N Definition:

- ◆ E.g. CMS50x50, CMS means wire mesh cable trays with double metal wires on the bottom along its length, 50x50 means HxW (inner size).
- ◆ Wire diameter range: 3.5mm-6.0mm (common diameter 5.0mm).
- ◆ CMS50 series is generally applied to machanical equipment.

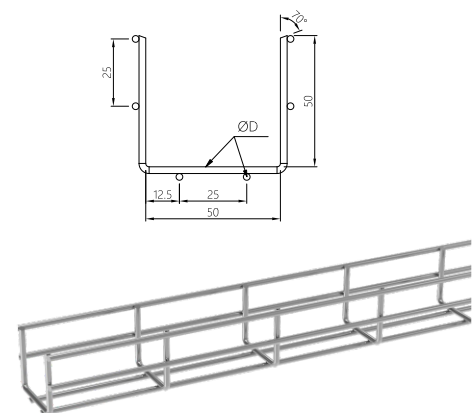

TCM SELF-LOCK SERIES

Default unit: mm

Part Number	Height	Width	Length	Wire Diameter	Weight
ALL TCM40x40	40	40	3000	4.0	1.98kg
ALL TCM40x90	40	90	3000	4.0	2.70kg

P/N Definition:

- ◆ E.g. TCM-W12x12, TCM means self-locking wire mesh cable tray, 12x12 means HxW (inner size).
- ◆ Wire diameter range: 3.5mm-6.0mm (common diameter 4.0mm).
- ◆ CMS50 series is generally applied to machanical equipment.

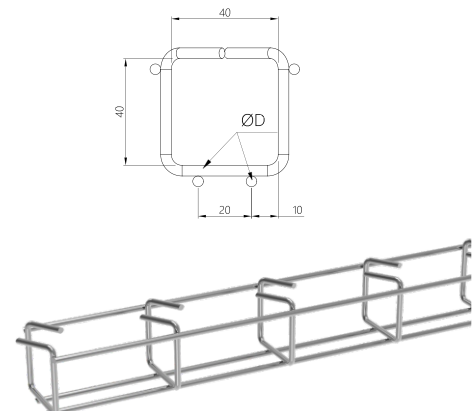

SELF-LOCKING COVER

Part Number	Height	Width	Length	Weight
PJ-RCVR100-1000	8.5	100	1m	1.12kg
PJ-RCVR150-1000	8.5	150	1m	1.52kg
PJ-RCVR200-1000	8.5	200	1m	1.91kg
PJ-RCVR300-1000	8.5	300	1m	2.69kg
PJ-RCVR400-1000	8.5	400	1m	3.48kg
PJ-RCVR450-1000	8.5	450	1m	3.87kg
PJ-RCVR500-1000	8.5	500	1m	4.26kg
PJ-RCVR600-1000	8.5	600	1m	5.05kg

P/N Definition:

- ◆ E.g. PJ-RCVR100-1000, PJ means wire mesh cable tray accessories, RCVR means self-locking cover, 100 means 100mm width 1000 means 1000mm length.

Instruction Manual:

- ◆ Suitable for: cover for wire mesh cable trays.
- ◆ Fit for: wire diameter from 3.5mm to 6.0mm, covering all sizes of cable trays.

Default unit: mm

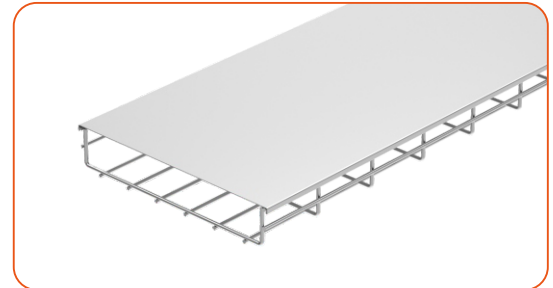
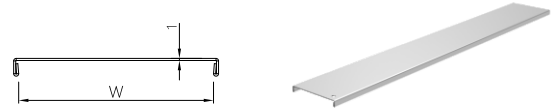

DIVIDER

Part Number	Height	Width	Length	Weight
PJ-DVR50-1000	47.5	25.5	1m	0.60kg
PJ-DVR100-1000	75.0	25.5	1m	0.81kg
PJ-DVR150-1000	125.0	25.5	1m	1.27kg
PJ-DVR50-3000	47.5	25.5	3m	1.80kg
PJ-DVR100-3000	75.0	25.5	3m	2.43kg
PJ-DVR150-3000	125.0	25.5	3m	3.81kg

P/N Definition:

- ◆ E.g. PJ-DVR50-1000, PJ means wire mesh cable tray accessories, DVR means divider, 50 means it fits 50mm high wire mesh cable trays, 1000 means 1000mm long per piece.

Instruction Manual:

- ◆ Suitable for: Isolating strong and weak electricity, often used in data center.
- ◆ Fit for: wire diameter from 3.5mm to 6.0mm, covering all sizes of cable trays.
- ◆ Includes: cover ×1, M6x20 bolts ×3; M6 nuts ×3; clip ×3

Default unit: mm

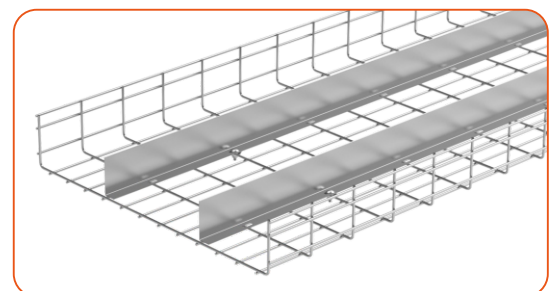
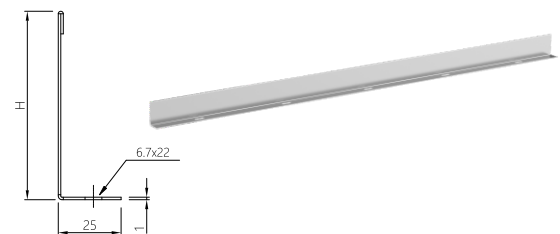

REINFORCED DIVIDER

Default unit: mm

Part Number	Height	Width	Length	Weight/PCS
ALL PJ-HJDVR50-1000	47.5	24.5	1m	0.63 kg
ALL PJ-HJDVR100-1000	80.0	24.5	1m	0.89 kg
ALL PJ-HJDVR150-1000	125.0	24.5	1m	1.23 kg
ALL PJ-HJDVR50-3000	47.5	24.5	3m	1.88 kg
ALL PJ-HJDVR100-3000	80.0	24.5	3m	2.66 kg
ALL PJ-HJDVR150-3000	125.0	24.5	3m	3.70 kg

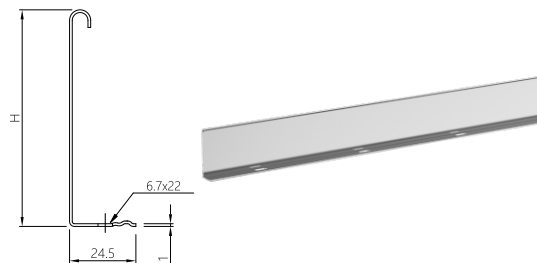

P/N Definition:

- ◆ E.g. PJ-HJDVRB50-1000, PJ means wire mesh cable tray accessories, HJDVRB means reinforced divider; 50 means it fits 50mm high wire mesh cable trays, 1000 means 1000mm long.

Instruction Manual:

- ◆ Suitable for: isolating strong and weak electricity, often used for mechanical equipment.
- ◆ Fit for: wire diameter from 3.5mm to 6.0mm, covering all sizes of cable trays.
- ◆ Includes: cover ×1, M6×20 carriage bolt ×3.

KKY COUPLER

Default unit: mm

Part Number	Height	Width	Pack	Weight
ALL PJ-KKY-SET	19	2.75	20	0.8kg

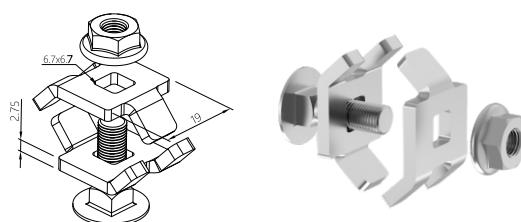

Instruction Manual:

- ◆ Suitable for: connecting wire mesh cable trays.
- ◆ Fit for: diameter of wire from 3.5mm to 6.0mm.
- ◆ Includes: KKY ×2, M6×20 bolt ×1, M6 nut ×1.



KK34 COUPLER

Default unit: mm

Part Number	Height	Width	Pack	Weight
PJ-KK34-SET	11	34	20	0.80kg

Instruction Manual:

- ◆ Suitable for: connecting wire mesh cable trays.
- ◆ Fit for: diameter of wire from 4.0mm to 6.0mm.
- ◆ Includes: KK34-top ×1, KK34-bottom ×1, M6×20 bolt ×1, M6 nut ×1.

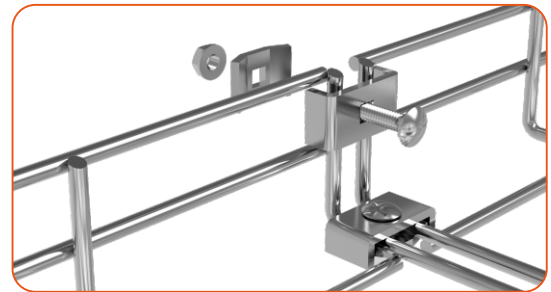
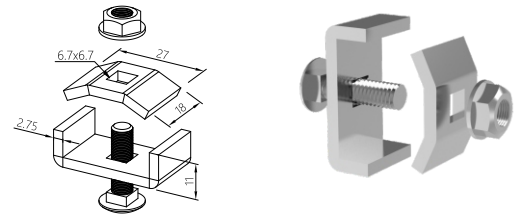

KK28 COUPLER

Default unit: mm

Part Number	Height	Width	Pack	Weight
PJ-KK28-SET	11	28	300	12.00kg

Instruction Manual:

- ◆ Suitable for: connecting wire mesh cable trays.
- ◆ Fit for: diameter of wire from 3.5mm to 5.0mm.
- ◆ Includes: KK28-top ×1, KK28-bottom ×1, M6×20 bolt ×1, M6 nut ×1.

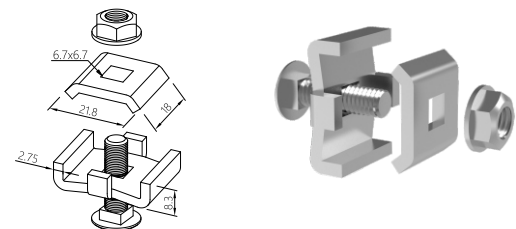

BOLTLESS SIDE COUPLER

Default unit: mm

Part Number	Height	Width	Pack	Weight
ALL PJ-BLC	25	250	100	7.30kg

Instruction Manual:

- ◆ Apply to: Quick connecting wire mesh cable trays.
- ◆ Suit for: Diameter of wire from 3.5mm to 6.0mm.
- ◆ Include: Boltless side coupler x 1.

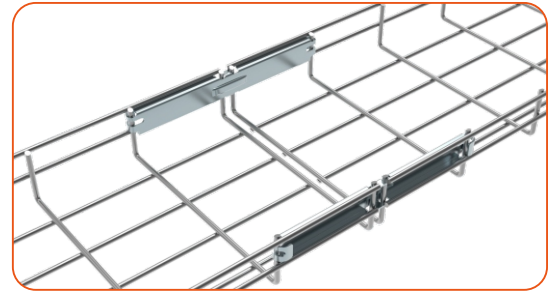
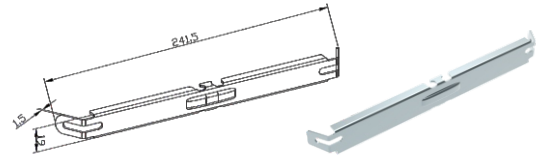

STRENGTHENING BAR

Default unit: mm

Part Number	Height	Width	Pack	Weight
ALL PJ-SBR-SET	19	250	100	15.00kg

Instruction Manual:

- ◆ Suitable for: connecting wire mesh cable trays.
- ◆ Fit for: diameter of wire from 3.5mm to 6.0mm.
- ◆ Includes: bar x1, KK34-top x3, M6x20 bolt x3, M6 nut x3.

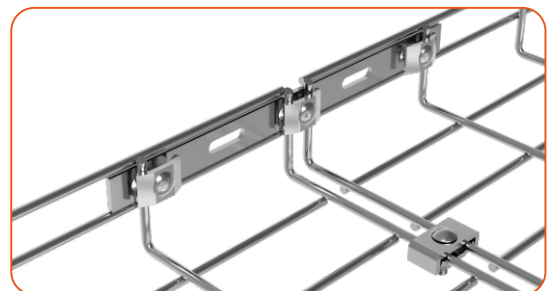
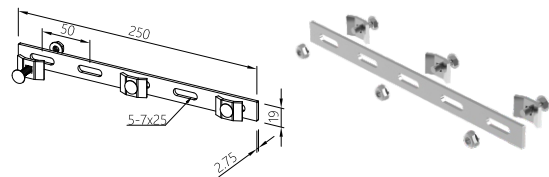

CORNER STRENGTHENING BAR

Default unit: mm

Part Number	Height	Width	Pack	Weight
PJ-CSB-SET	19	227	100	31.00kg

Instruction Manual:

- ◆ Suitable for: connecting elbows, tees, and crosses.
- ◆ Fit for: diameter of wire from 3.5mm to 6.0mm.
- ◆ Includes: bar ×1, KK34-top ×4, M6×20 bolt ×4, M6 nut ×4.

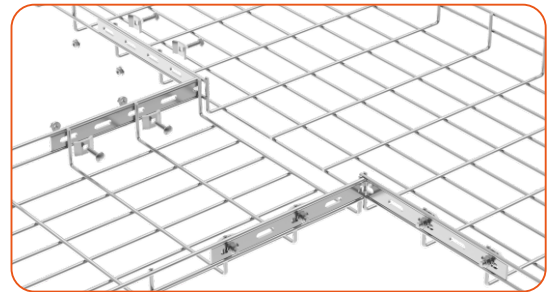
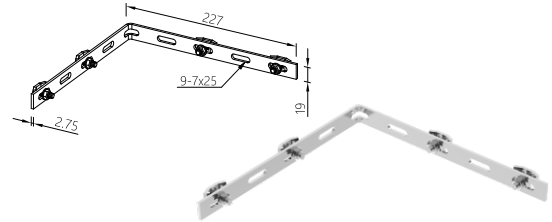

RADIAN CONNECTOR

Default unit: mm

Part Number	Height	Width	Pack	Weight
PJ-RC90-50-SET	50	304	50	20.00kg
PJ-RC90-100-SET	100	30	15.00kg	
PJ-RC90-150-SET	150	304	30	18.00kg

Instruction Manual:

- ◆ Suitable for: connecting elbows, tees, and crosses.
- ◆ Fit for: diameter of wire from 3.5mm to 6.0mm.
- ◆ Includes: bar ×1, KK34-top ×6, M6×20 bolt ×6, M6 nut ×6.

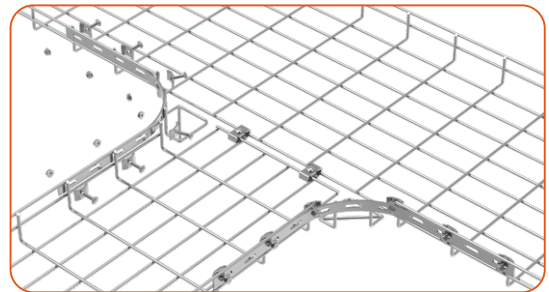
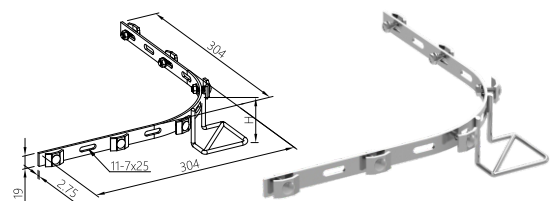

ADJUSTABLE CONNECTOR

Part Number	Height	Width	Weight
ALL PJ-AJC-SET	19	192	0.23kg

Instruction Manual:

- ◆ Suitable for: connecting risers.
- ◆ Fit for: diameter of wire from 3.5mm to 6.0mm.
- ◆ Includes: bar ×2, KK34-top ×4, M6×20 bolt ×5, M6 nut ×5.

Default unit: mm

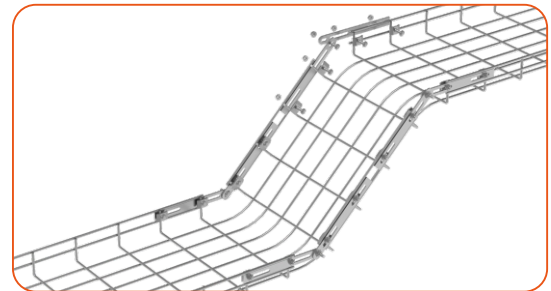
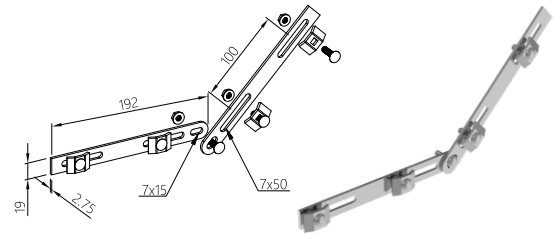

CABLE DROP-OUT

Part Number	Height	Width	Pack	Weight
ALL PJ-CGD	192	90	50	9.00kg

Instruction Manual:

- ◆ Suitable for: cable drop out.
- ◆ Fit for: wire diameter from 3.5mm to 6.0mm, wire mesh cable tray width over 150mm.

Default unit: mm

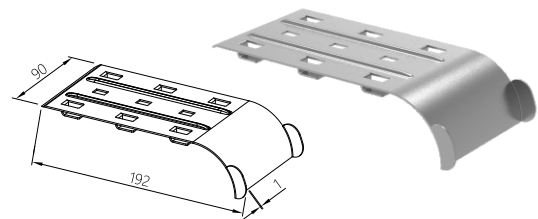

CAP

Default unit: mm

Part Number	Height	Pack	Weight
PJ-CAP-4.0-PT	12	100	0.10kg
PJ-CAP-5.0-PT	12	100	0.10kg
PJ-CAP-6.0-PT	12	100	0.10kg

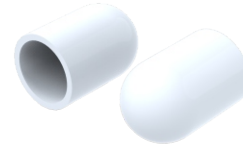

Instruction Manual:

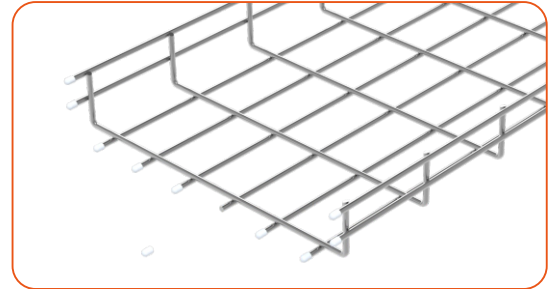
- ◆ Suitable for: covering the shear points of metal wires.
- ◆ Fit for: wire diameter from 4.0mm to 6.0mm.

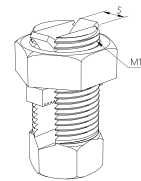

EARTHING BOLT

Default unit: mm

Part Number	Height	Diameter	Weight
PJ-EHB-5	26	M12	0.03kg
PJ-EHB-6	27	M14	0.07kg

Instruction Manual:

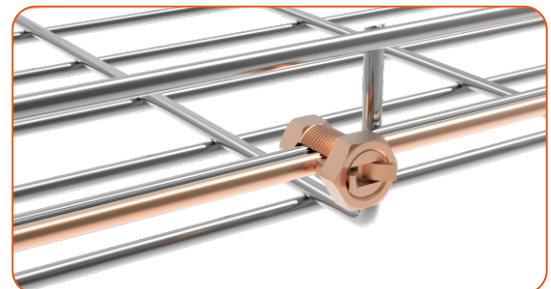
- ◆ Suitable for: ground connection.
- ◆ Fit for: PJ-EHB-5 used for diameter below 5.0mm, PJ-EHB-6 used for diameter from 5.0mm to 7.0mm.



SIGNAGE

Default unit: mm

Part Number	Height	Width	Weight
ALL PJ-SGN-PT	120	17	0.005kg

Instruction Manual:

- ◆ Suitable for: displaying company logo.
- ◆ Fit for: wire diameter from 4.0mm to 6.0mm.

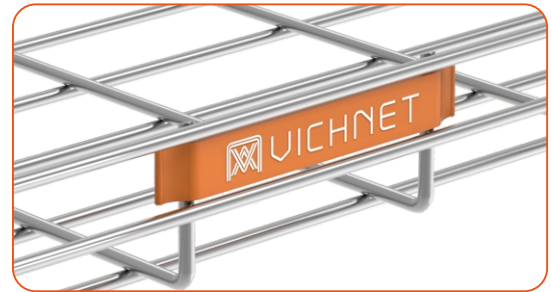

TERMINATOR

Default unit: mm

Part Number	Height	Width	Weight
ALL PJ-TTR50-100	50	100	0.07kg
ALL PJ-TTR50-200	50	200	0.13kg
ALL PJ-TTR50-300	50	300	0.19kg
ALL PJ-TTR100-100	100	100	0.08kg
ALL PJ-TTR100-200	100	200	0.14kg
ALL PJ-TTR100-300	100	300	0.20kg

Instruction Manual:

- ◆ Suitable for: enclosing the ends of wire mesh cable trays.
- ◆ Fit for: wire diameter from 3.5mm to 6.0mm, covering all sizes of cable trays.

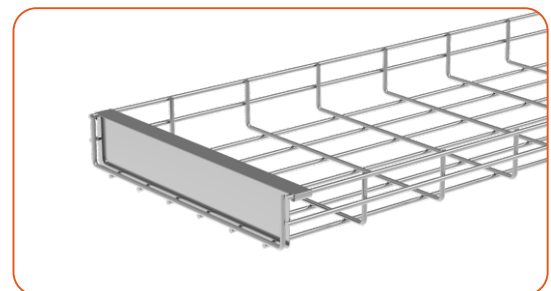
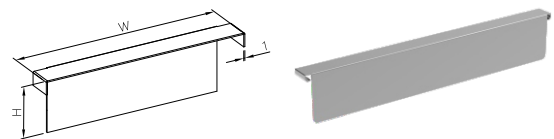

SPIDER BRACKET

Default unit: mm

Part Number	Height	Length	Thickness	Pack	Weight
PJ-SPB	75	92	2.0	100	0.11kg

Instruction Manual:

- ◆ Suitable for: connection to equipment or junction box.
- ◆ Fit for: wire diameter from 3.5mm to 6.0mm.

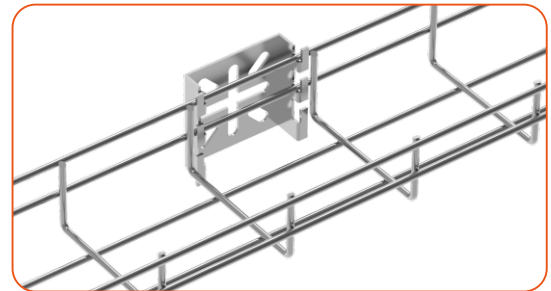
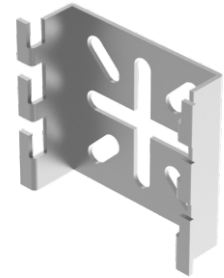
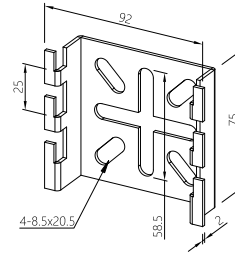

WIRE CUTTER

Default unit: mm

Part Number	Diameter	Length	Weight/PCS
GBJ-CUT	Up to 8mm	24"	1.50kg

Instruction Manual:

- ◆ Suitable for: cutting wire to make elbows on site.
- ◆ Fit for: wire diameter from 3.5mm to 8.0mm.

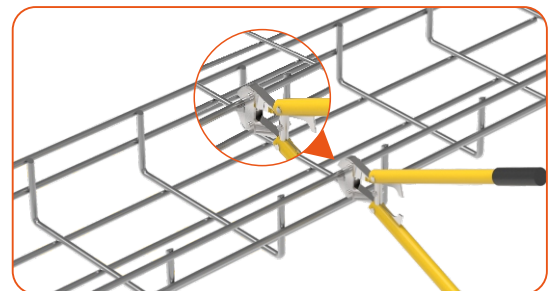

COVER

Default unit: mm

Part Number	Height	Width	Length	Weight
ALL PJ-CVRC100-1000	8.5	100	1m	1.46kg
ALL PJ-CVRC150-1000	8.5	150	1m	1.97kg
ALL PJ-CVRC200-1000	8.5	200	1m	2.48kg
ALL PJ-CVRC300-1000	8.5	300	1m	3.50kg
ALL PJ-CVRC400-1000	8.5	400	1m	4.52kg
ALL PJ-CVRC450-1000	8.5	450	1m	5.03kg
ALL PJ-CVRC500-1000	8.5	500	1m	5.54kg
ALL PJ-CVRC600-1000	8.5	600	1m	6.56kg
ALL PJ-CVRC100-3000	8.5	100	3m	4.38kg
ALL PJ-CVRC150-3000	8.5	150	3m	5.91kg
ALL PJ-CVRC200-3000	8.5	200	3m	7.44kg
ALL PJ-CVRC300-3000	8.5	300	3m	10.50kg
ALL PJ-CVRC400-3000	8.5	400	3m	13.56kg
ALL PJ-CVRC450-3000	8.5	450	3m	15.09kg
ALL PJ-CVRC500-3000	8.5	500	3m	16.62kg
ALL PJ-CVRC600-3000	8.5	600	3m	19.68kg

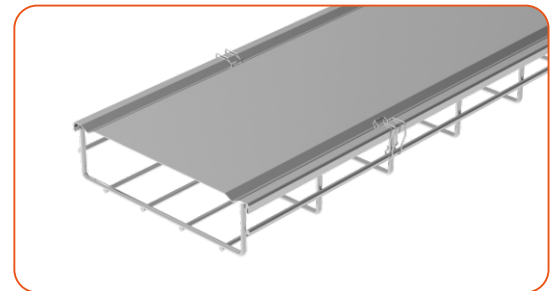
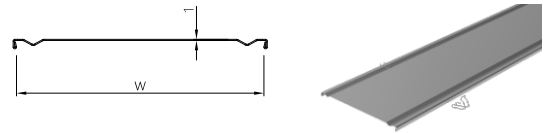

P/N Definition:

- ◆ E.g. PJ-CVRC100-3000, PJ means wire mesh cable tray accessories, CVRC means wire mesh cable tray cover, 100 means 100mm high, 3000 means 3000mm long per piece.

Instruction Manual:

- ◆ Suitable for: cover for wire mesh cable trays.
- ◆ Fit for: wire diameter from 3.5mm to 6.0mm, wire mesh cable tray width over 100mm.
- ◆ Includes: cover ×1, cover clamp ×4.

FAST LOCK

Default unit: mm

Part Number	Height	Length	Pack	Weight
ALL PJ-FLK	19	43	500	7.50kg

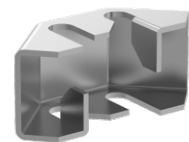
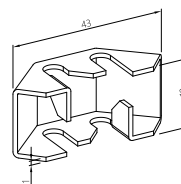

Instruction Manual:

- ◆ Suitable for: making bends.
- ◆ Fit for: diameter of wire from 4.0mm to 6.0mm.

INDUSTRIAL MOUNT BRACKET

Default unit: mm

Part Number	Height	Width	Weight
PJ-LJQD	172	130	0.60kg

Instruction Manual:

- ◆ Suitable for: connection to equipment or junction box.
- ◆ Fit for: wire diameter from 3.5mm to 6.0mm.

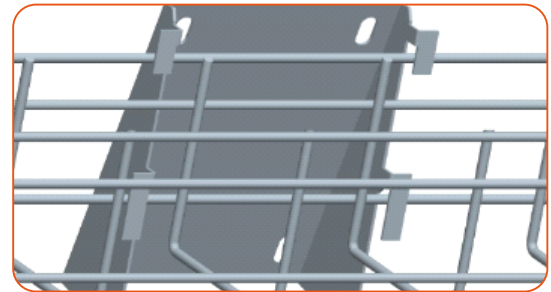
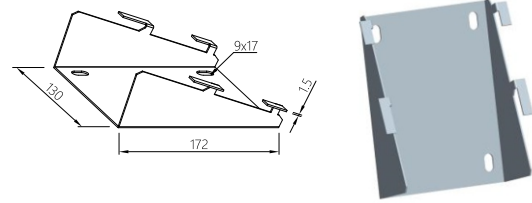

TUBE OUTLET

Default unit: mm

Part Number	Length	Width	Weight
PJ-CDH	109	66	0.12kg

Instruction Manual:

- ◆ Suitable for: connection to tube with diameter 32mm, 25mm & 20mm.
- ◆ Fit for: wire diameter from 3.5mm to 6.0mm.

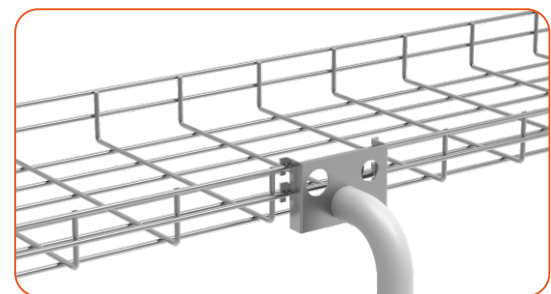
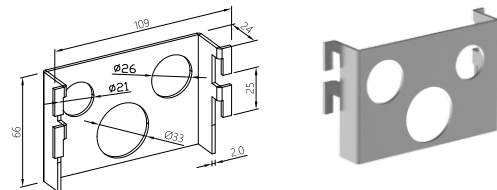

TRAPEZE BAR

Default unit: mm

Part Number	Height	Width	Length	Thickness	Pack	Weight
ALL PJ-BR100	22	53	200	2.0	50	0.23kg
ALL PJ-BR150	22	53	250	2.0	50	0.29kg
ALL PJ-BR200	22	53	300	2.0	30	0.35kg
ALL PJ-BR300	22	53	400	2.0	30	0.46kg
ALL PJ-BR400	22	53	500	2.0	30	0.59kg
ALL PJ-BR450	22	53	550	2.0	20	0.65kg
ALL PJ-BR500	22	53	600	2.0	20	0.70kg
ALL PJ-BR600	22	53	700	2.0	20	0.82kg

Instruction Manual:

- ◆ Suitable for: Hanging trays are often installed with.
- ◆ Fit for: diameter of wire from 3.5mm to 6.0mm
- ◆ Hanging trays are often installed with M10 threaded rod, drop in anchor bolt, and flange nut.

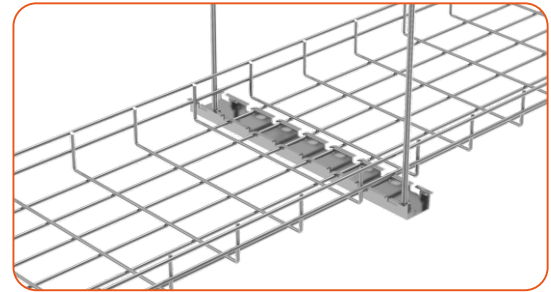
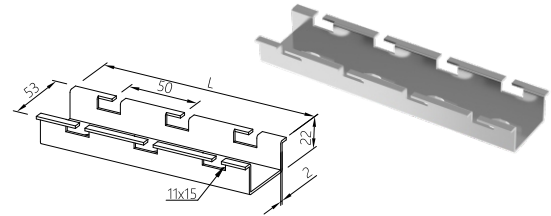

STRUT CHANNEL BAR WITH KSK

Default unit: mm

Part Number	Height	Width	Length	Thickness	Weight
ALL PJ-UHDC100	41	41	200	2.0	0.40kg
ALL PJ-UHDC150	41	41	250	2.0	0.68kg
ALL PJ-UHDC200	41	41	300	2.0	0.75kg
ALL PJ-UHDC300	41	41	400	2.0	0.89kg
ALL PJ-UHDC400	41	41	500	2.0	1.10kg
ALL PJ-UHDC450	41	41	550	2.0	1.21kg
ALL PJ-UHDC500	41	41	600	2.0	1.31kg
ALL PJ-UHDC600	41	41	700	2.0	1.52kg

Instruction Manual:

- ◆ Suitable for: hanging trays, also can be used for wall & floor mount.
- ◆ Fit for: diameter of wire from 3.5mm to 6.0mm.
- ◆ Hanging trays are often installed with M12 threaded rod, drop in anchor bolt, and flange nut.

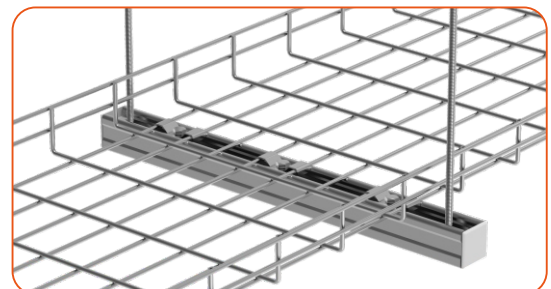
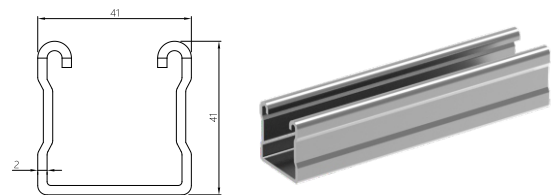

HOLD DOWN CLIP SET

Default unit: mm

Part Number	Width	Thickness	Weight
PJ-HDC	59	1.5	0.055kg

Instruction Manual:

- ◆ Suitable for: fixing trays on strut channel bar.
- ◆ Fit for: diameter of wire from 3.5mm to 6.0mm.
- ◆ Includes: clip x1, M6 spring nut x1, M6 bolt x1.

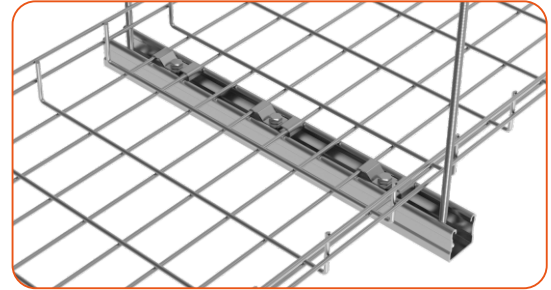
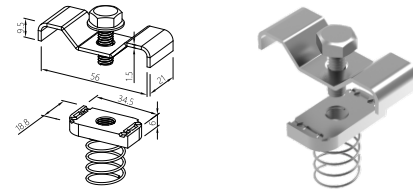

FAST CHANNEL CLIP

Default unit: mm

Part Number	Weight
PJ-KSK	0.01kg

Instruction Manual:

- ◆ Suitable for: fixing trays on strut channel bar.
- ◆ Fit for: diameter of wire from 3.5mm to 6.0mm.

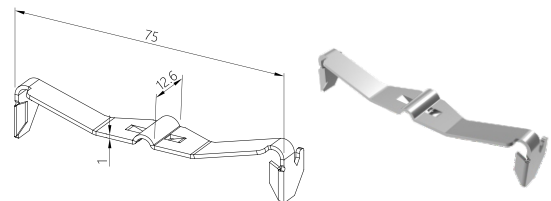

THREADED ROD

Default unit: mm

Part Number	Diameter	Length	Length	Weight
ALL TY-ROD-M8x1000	8	1000	1m	0.26kg
ALL TY-ROD-M8x3000	8	3000	3m	0.78kg
ALL TY-ROD-M10x1000	10	1000	1m	0.40kg
ALL TY-ROD-M10x3000	10	3000	3m	1.20kg
ALL TY-ROD-M12x1000	12	1000	1m	0.64kg
ALL TY-ROD-M12x3000	12	3000	3m	1.89kg
ALL TY-ROD-M14x1000	14	1000	1m	0.85kg
ALL TY-ROD-M14x3000	14	3000	3m	2.50kg

Instruction Manual:

- ◆ Suitable for: fixing the threaded rod to the ceiling.
- ◆ Often used with drop in anchor bolt, flange nut, can be ordered in 3-meter length and cut freely on project site.

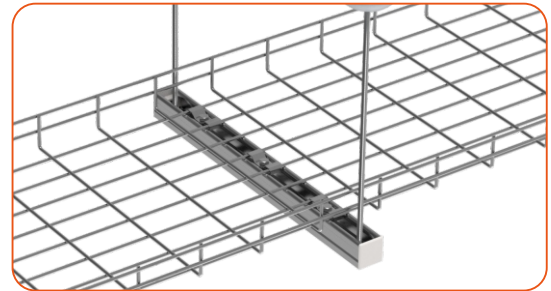

DROP IN ANCHOR BOLT

Default unit: mm

Part Number	Diameter	Length	Weight
ALL TY-PANR-M8x50	8	50	0.01kg
ALL TY-PANR-M10x60	10	60	0.01kg
ALL TY-PANR-M12x70	12	70	0.03kg

Instruction Manual:

- ◆ Suitable for: fixing trapeze or strut channel bars to the ceiling.



FLANGE NUT

Default unit: mm

Part Number	Type	Diameter	Weight
TY-FNUT-M8	flange nut	8	0.010kg
TY-FNUT-M10	flange nut	10	0.011kg
TY-FNUT-M12	flange nut	12	0.012kg
TY-FNUT-M14	flange nut	14	0.014kg
TY-FNUT-M16	flange nut	16	0.015kg
TY-DNUT-M8	dome nut	8	0.010kg
TY-DNUT-M10	dome nut	10	0.011kg
TY-DNUT-M12	dome nut	12	0.012kg
TY-DNUT-M14	dome nut	14	0.014kg



Instruction Manual:

- ◆ Suitable for: flange nut is for fixing threaded rods, dome nut is for threaded rod end decoration.

ROD CAP

Default unit: mm

Part Number	Diameter	Weight
TY-RODCAP-M10	10	0.012kg
TY-RODCAP-M12	12	0.025kg

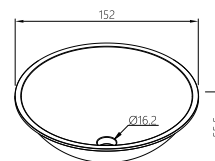

Instruction Manual:

- ◆ Suitable for: threaded rod top decoration.

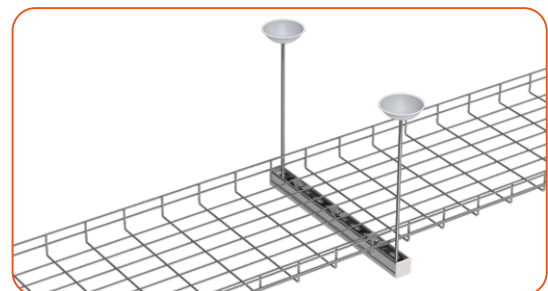

STRUT CHANNEL TERMINATOR

Default unit: mm

Part Number	Height	Width	Weight
ALL PJ-CCT-PT	41	21	0.003kg
ALL PJ-CCT-PT	41	41	0.006kg

Instruction Manual:

- ◆ Suitable for: end cover for strut channel.
- ◆ Fit for: 41mm×41mm, 41mm×21mm strut channel.

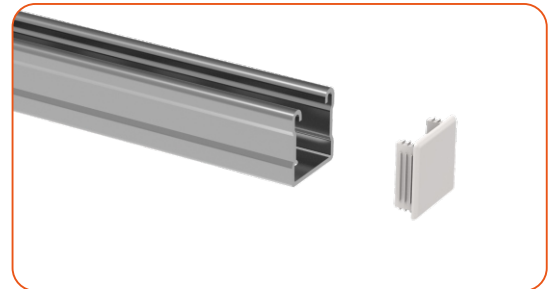

M SHAPED BAR

Default unit: mm

Part Number	Height	Width	Length	Thickness	Pack	Weight
ALL PJ-MBR100	24	63	200	1.5	50	14.40kg
ALL PJ-MBR150	24	63	250	1.5	50	18.00kg
ALL PJ-MBR200	24	63	300	1.5	50	21.60kg
ALL PJ-MBR300	24	63	400	1.5	50	28.80kg
ALL PJ-MBR400	24	63	500	1.5	40	28.80kg
ALL PJ-MBR450	24	63	550	1.5	40	31.70kg
ALL PJ-MBR500	24	63	600	1.5	40	34.40kg
ALL PJ-MBR600	24	63	700	1.5	40	41.60kg

Instruction Manual:

- ◆ Suitable for: hanging trays are often installed with.
- ◆ Fit for: diameter of wire from 3.5mm to 6.0mm.
- ◆ Hanging trays are often installed with M8 threaded rod, drop in anchor bolt, and flange nut.

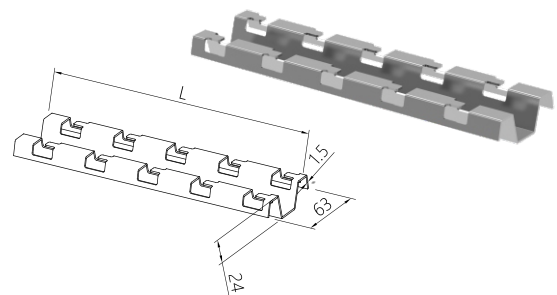

HANGING HOOK

Default unit: mm

Part Number	Height	Width	Length	Thickness	Pack	Weight
PJ-HKS	42	38.5	35	2.0	500	21.5kg

Instruction Manual:

- ◆ Suitable for: hanging trays are often installed with.
- ◆ Fit for: diameter of wire from 3.5mm to 6.0mm, the width of tray should be ≤ 200 mm.
- ◆ Hanging trays are often installed with M8 threaded rod, drop in anchor bolt, and flange nut.

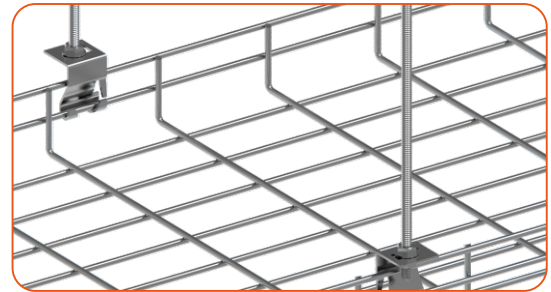
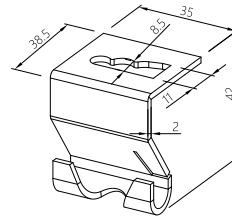

50 TRAY HOLDER

Default unit: mm

Part Number	Height	Width	Length	Thickness	Pack	Weight
PJ-THR	25	25	72	2.0	500	25.00kg

Instruction Manual:

- ◆ Suitable for: hanging trays are often installed with.
- ◆ Fit for: diameter of wire from 3.5mm to 6.0mm, the width of tray is 50mm
- ◆ Hanging trays are often installed with M10 threaded rod, drop in anchor bolt, and flange nut

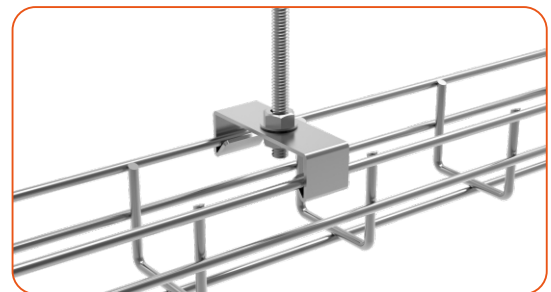
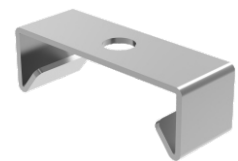
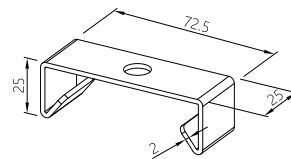

FLAG TYPE HANGING BRACKET

Default unit: mm

Part Number	Height	Weight
EZ PJ-RFB100	500	1.82kg
EZ PJ-RFB150	500	1.88kg
EZ PJ-RFB200	500	1.92kg
EZ PJ-RFB300	500	2.11kg
EZ PJ-RFB400	500	2.40kg
EZ PJ-RFB450	500	2.49kg
EZ PJ-RFB500	500	2.57kg
EZ PJ-RFB600	500	2.72kg

Instruction Manual:

- ◆ Suitable for: hanging trays under ceiling, can support two trays side by side.
- ◆ Fit for: diameter of wire from 3.5mm to 6.0mm.
- ◆ Includes: bracket x1, pole x1.

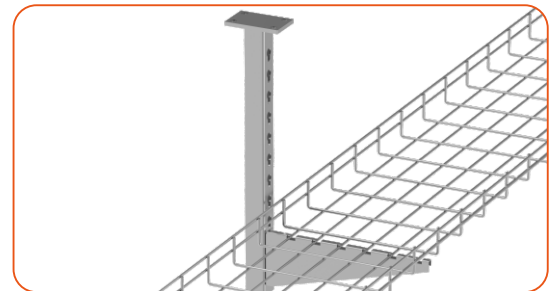
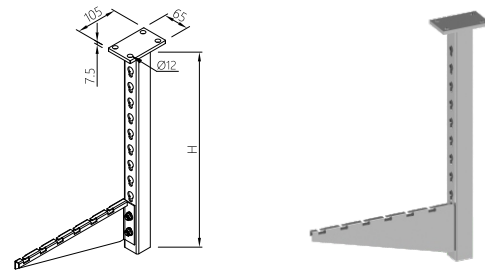

CLIP FOR I-BEAM

Default unit: mm

Part Number	Height	Width	Bore Diameter	Weight
EZ PJ-CIB	46	50	13	0.22kg
PC PJ-CIB	46	50	13	0.22kg
GI PJ-CIB	46	50	13	0.22kg
PC PJ-CIB	46	50	13	0.22kg

Instruction Manual:

- ◆ Suitable for: installation of wire mesh cable tray under I-beam or strut channel.
- ◆ Fit for: diameter of threaded rod from 10mm to 12mm.

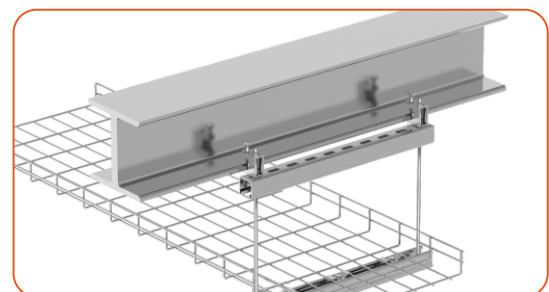
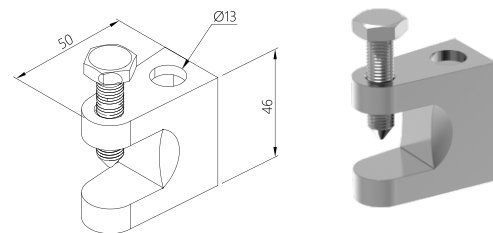

T-TYPE HANGING BRACKET

Default unit: mm

Part Number	Height	Width	Length	Thickness	Weight
PJ-THB	150	55	80	4.8	0.37kg

Instruction Manual:

- ◆ Suitable for: hanging trays are often installed with.
- ◆ Fit for: diameter of wire from 3.5mm to 6.0mm, width of trays from 100mm to 600mm.
- ◆ Hanging trays are often installed with concrete wedge anchor bolt.

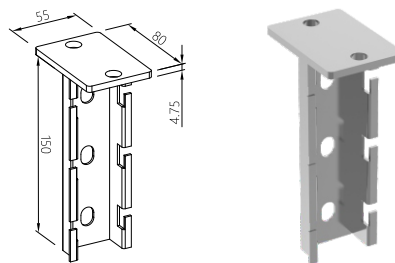

L-TYPE WALL BRACKET

Default unit: mm

Part Number	Height	Length	Thickness	Pack	Weight
ALL PJ-LWB100	168	166	2.0	30	0.42kg
ALL PJ-LWB150	168	216	2.0	30	0.47kg
ALL PJ-LWB200	168	266	2.0	30	0.53kg
ALL PJ-LWB300	168	366	2.0	20	0.62kg

Instruction Manual:

- ◆ Suitable for: supporting trays on wall.
- ◆ Fit for: diameter of wire from 3.5mm to 6.0mm, width from 100mm to 300mm.
- ◆ Includes: bracket x1 (bolt and nut optional).

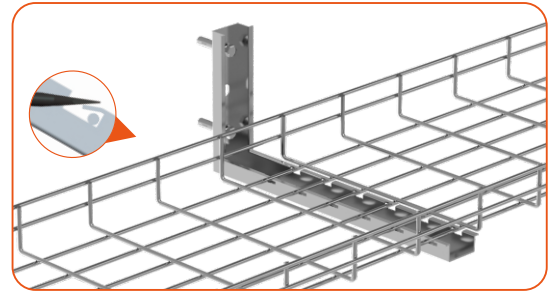
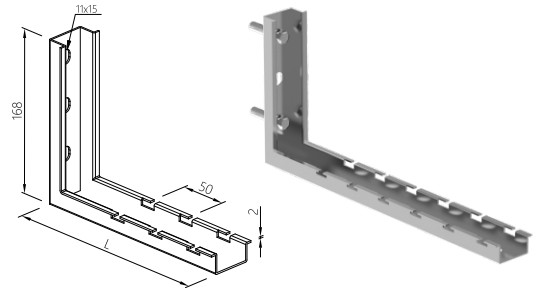

CANTILEVER WALL BRACKET

Default unit: mm

Part Number	Height	Length	Weight
ALL PJ-CWB150	230	200	1.01kg
ALL PJ-CWB200	230	250	1.28kg
ALL PJ-CWB300	230	350	1.19kg
ALL PJ-CWB400	230	450	1.48kg
ALL PJ-CWB450	230	500	1.53kg
ALL PJ-CWB500	230	550	1.59kg
ALL PJ-CWB600	230	650	1.72kg

Instruction Manual:

- ◆ Suitable for: supporting trays on wall.
- ◆ Fit for: diameter of wire from 3.5mm to 6.0mm, width from 150mm to 900mm.
- ◆ Includes: bracket x1 (bolt and nut optional).

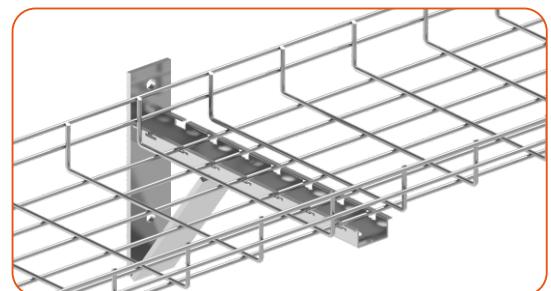
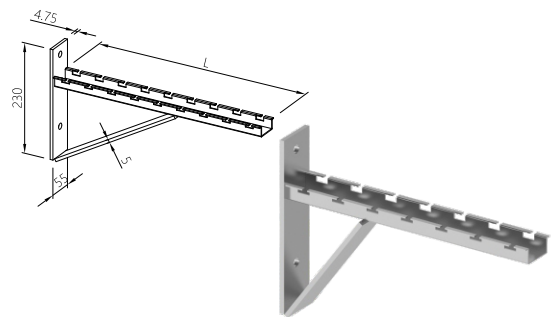

T-TYPE WALL BRACKET

Default unit: mm

Part Number	Height	Length	Weight
PJ-CRP100	84	122	0.32kg
PJ-CRP150	84	172	0.34kg
PJ-CRP200	84	222	0.35kg
PJ-CRP300	84	322	0.38kg

Instruction Manual:

- ◆ Suitable for: supporting trays on wall.
- ◆ Fit for: diameter of wire from 3.5mm to 6.0mm, tray width from 100mm to 300mm.
- ◆ Includes: bracket x1, KK34-top x2, M6x20 bolt x2, M6 nut x2.

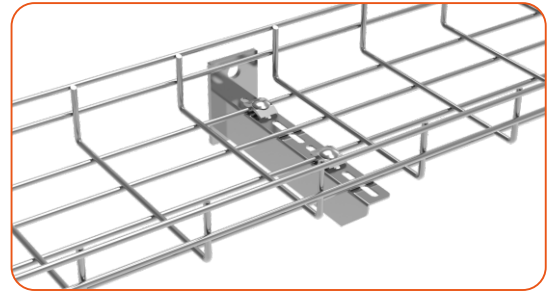
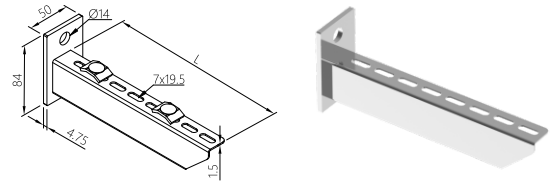

STRUT CHANNEL WALL BRACKET

Default unit: mm

Part Number	Height	Length	Thickness	Weight
PJ-TWH100	139	120	2.0	0.9kg
PJ-TWH150	139	170	2.0	1.02kg
PJ-TWH200	139	220	2.0	1.14kg
PJ-TWH300	139	320	2.0	1.34kg

Instruction Manual:

- ◆ Suitable for: supporting trays on wall.
- ◆ Fit for: tray width from 100mm to 300mm.
- ◆ Includes: bracket x1, fast channel clip x1.

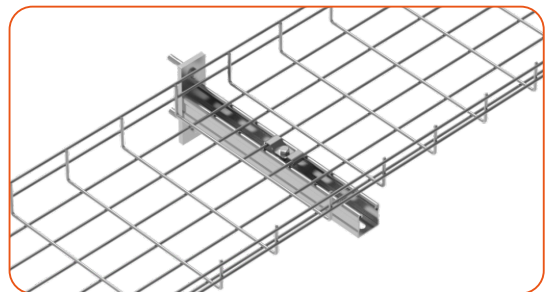
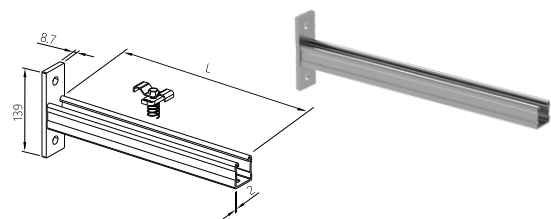

SPIDER BRACKET

Default unit: mm

Part Number	Height	Length	Thickness	Pack	Weight
ALL PJ-SPB	75	92	2.0	100	0.11kg

Instruction Manual:

- ◆ Suitable for: supporting trays on wall.
- ◆ Fit for: diameter of wire from 3.5mm to 6.0mm, Tray width from 50mm to 200mm.
- ◆ Includes: bracket x1 (bolt and nut optional).

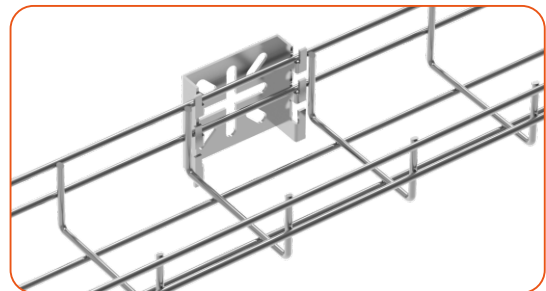
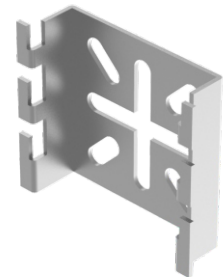
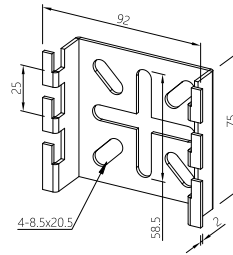

CONCRETE WEDGE ANCHOR BOLT

Default unit: mm

Part Number	Diameter	Length	Weight
ALL TY-CANR-M8x70	8	70	0.010kg
ALL TY-CANR-M8x80	8	80	0.011kg
ALL TY-CANR-M10x70	10	70	0.013kg
ALL TY-CANR-M12x70	12	70	0.016kg
ALL TY-CANR-M14x100	14	100	0.021kg

Instruction Manual:

- ◆ Suitable for: fixing brackets on wall or floor.



WALL BRACKET

Default unit: mm

Part Number	Height	Length	Thickness	Pack	Weight
PJ-WBK100	100	120	2.0	50	0.20kg
PJ-WBK150	100	170	2.0	50	0.26kg
PJ-WBK200	100	220	2.0	30	0.30kg
PJ-WBK300	100	320	2.0	30	0.49kg

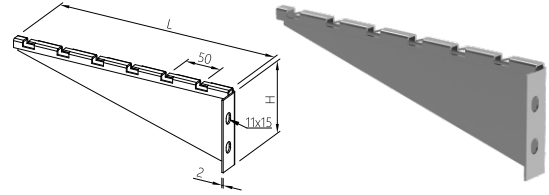

Instruction Manual:

- ◆ Suitable for: supporting trays on walls.
- ◆ Fit for: diameter of wire from 3.5mm to 6.0mm, tray width from 100mm to 600mm.
- ◆ Includes: bracket x1 (bolt and nut optiona).

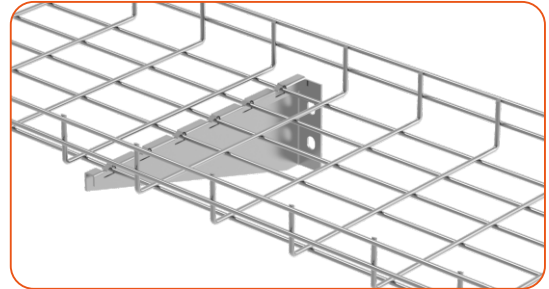

T-TYPE WALL HOLDER

Default unit: mm

Part Number	Height	Length	Thickness	Weight
PJ-TWH400	215	420	2.0	2.32kg
PJ-TWH450	215	470	2.0	2.43kg
PJ-TWH500	215	520	2.0	2.54kg
PJ-TWH600	215	620	2.0	2.76kg

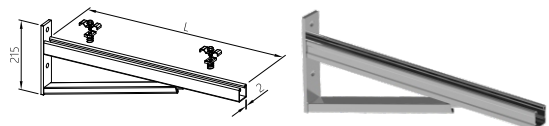

Instruction Manual:

- ◆ Suitable for: supporting trays on walls.
- ◆ Fit for: diameter of wire from 3.5mm to 6.0mm, tray width from 400mm to 900mm.
- ◆ Includes: bracket x1, fast channel clip x3.

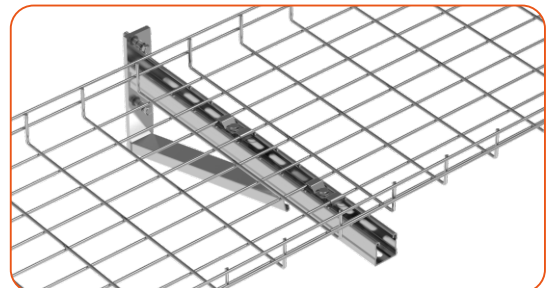

CABINET TOP STAND

Default unit: mm

Part Number	Height	Length	Thickness	Pack	Weight
ALL PJ-EFS100	120	100	2.0	20	1.31kg
ALL PJ-EFS150	120	150	2.0	20	1.44kg
ALL PJ-EFS200	120	200	2.0	20	1.51kg
ALL PJ-EFS300	120	300	2.0	20	1.67kg
ALL PJ-EFS400	120	400	2.0	20	1.76kg
ALL PJ-EFS450	120	450	2.0	20	1.83kg
ALL PJ-EFS500	120	500	2.0	20	1.91kg
ALL PJ-EFS600	120	600	2.0	20	2.05kg

Instruction Manual:

- ◆ Suitable for: supporting trays on cabinet tops or floors, with 120mm height, other height can be customized.
- ◆ Fit for: tray width from 100mm to 600mm.
- ◆ Includes: trapeze bar x1, foot x2, bolt & nut x1.

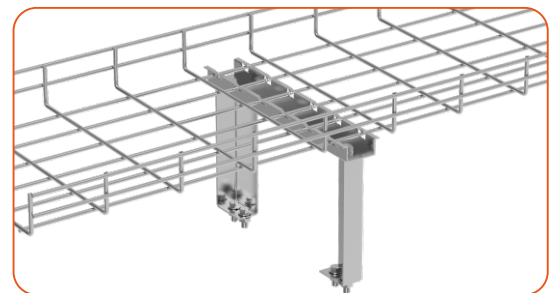
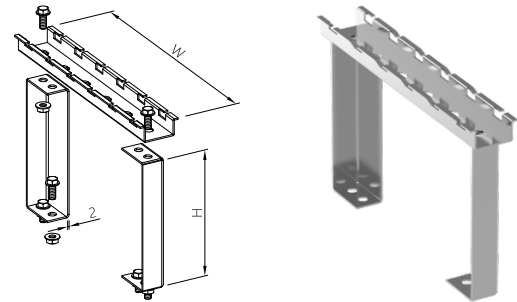

UNDERFLOOR BRACKET

Default unit: mm

Part Number	Adaptable Tray Width	Thickness	Pack	Weight
ALL PJ-UFB	100 - 500	2.0	14	1.06kg

Instruction Manual:

- ◆ Suitable for: supporting trays under raised floor.
- ◆ Fit for: diameter of wire from 3.5mm to 6.0mm, tray width from 100mm to 500mm.
- ◆ Includes: v clipx 2, trapeze bar x1, necessary bolt and nut.
- ◆ Feature: fix on feet of raised floor, height adjustable.

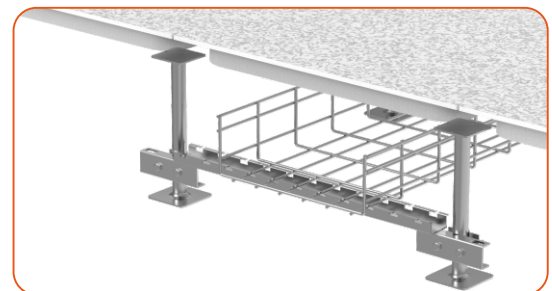
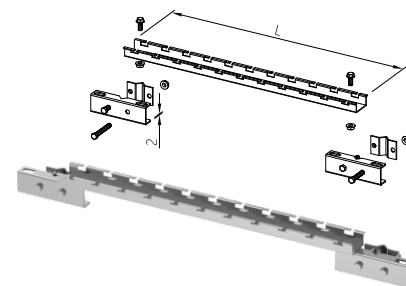

Bridge Type Stand

Part Number	Height	Length
PJ-BTS	300	200-600

Instruction Manual:

- ◆ Fit for: install single or double-layer of trays, height adjustable.
- ◆ Includes: THB x2, DXC x4, PRB x3, L type connector x4.

Default unit: mm

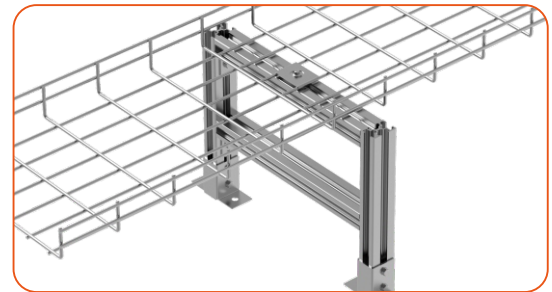
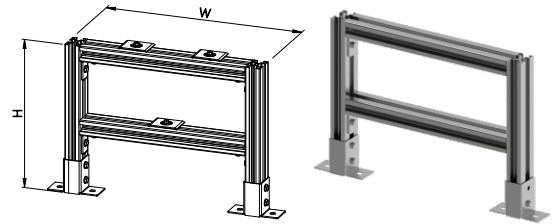

50 SIDE FLOOR BRACKET

Part Number	Height	Width	Length	Weight
PJ-50FSDB	56.5	50	70	0.13kg
PJ-75FSDB	56.5	75	70	0.14kg
PJ-100FSDB	56.5	70	0.17kg	

Instruction Manual:

- ◆ Suitable for: wall & floor mount, support span 1.4m.
- ◆ Fit for: wire diameter 4.0mm, width 50mm & 75mm & 100mm.

Default unit: mm

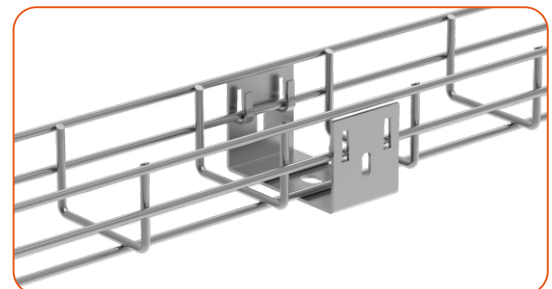
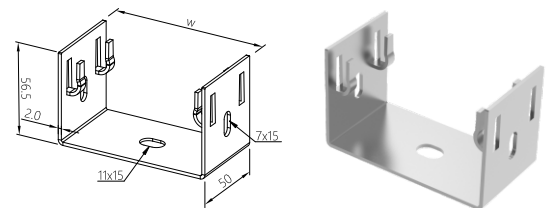

SPIDER BRACKET

Default unit: mm

Part Number	Height	Length	Thickness	Pack	Weight
ALL PJ-SPB	75	92	2.0	100	0.11kg

Instruction Manual:

- ◆ Suitable for: supporting trays on floor.
- ◆ Fit for: wire diameter from 3.5mm to 6.0mm, tray width from 100mm to 600mm.
- ◆ Includes: bracket x1 (bolt and nut optional).

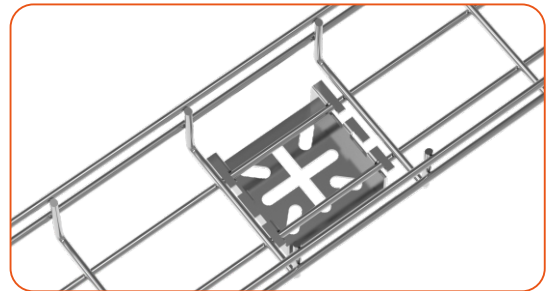
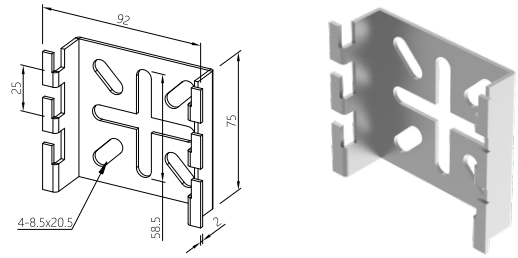

TRAPEZE BAR

Default unit: mm

Part Number	Height	Width	Length	Thickness	Pack	Weight
ALL PJ-BR100	22	53	200	2.0	50	0.23kg
ALL PJ-BR150	22	53	250	2.0	50	0.29kg
ALL PJ-BR200	22	53	300	2.0	30	0.35kg
ALL PJ-BR300	22	53	400	2.0	30	0.46kg
ALL PJ-BR400	22	53	500	2.0	30	0.59kg
ALL PJ-BR450	22	53	550	2.0	20	0.65kg
ALL PJ-BR500	22	53	600	2.0	20	0.70kg
ALL PJ-BR600	22	53	700	2.0	20	0.82kg

Instruction Manual:

- ◆ Suitable for: supporting trays on floor.
- ◆ Fit for: wire diameter from 3.5mm to 6.0mm.

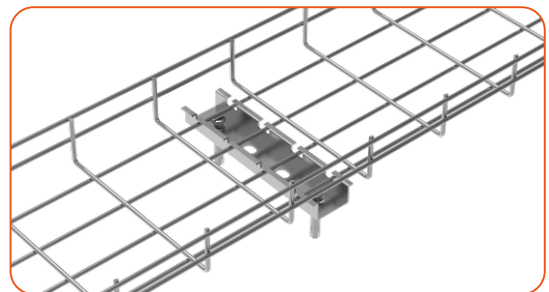
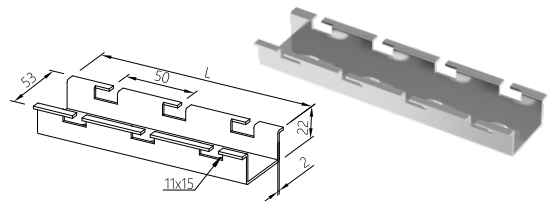

50 FLOOR STAND

Part Number	Height	Width	Length	Thickness	Pack	Weight
PJ-50FSD	48	35	72	2.0	100	0.07kg

Instruction Manual:

- ◆ Suitable for: supporting 50mm trays on floor or top of cabinet.
- ◆ Fit for: wire diameter from 3.5mm to 6.0mm, width=50mm.

Default unit: mm

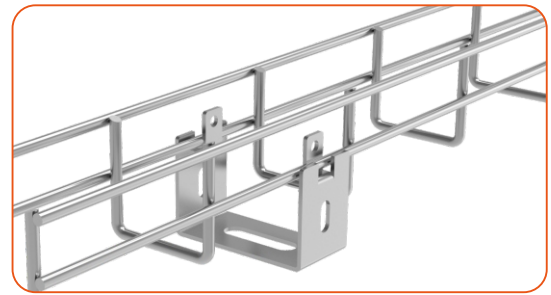
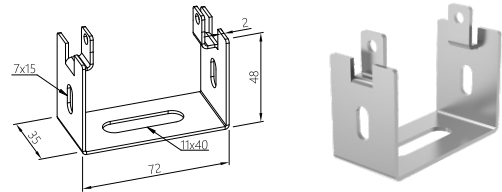

100 FLOOR STAND

Part Number	Height	Width	Length	Thickness	Pack	Weight
PJ-100FSD	64	64	98	1.0	100	0.14kg

Instruction Manual:

- ◆ Suitable for: supporting 100mm trays on floor or top of cabinet.
- ◆ Fit for: wire diameter from 3.5mm to 6.0mm, width=100mm.
- ◆ Includes: stand x1 (bolt and nut optional).

Default unit: mm

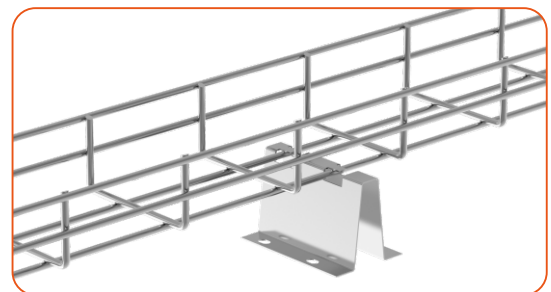
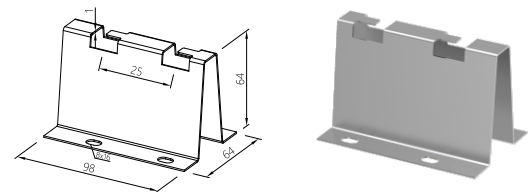

FLAG TYPE FLOOR STAND

Default unit: mm

Part Number	Height	Length	Weight
ALL PJ-FFS100	500	120	1.82kg
ALL PJ-FFS150	500	170	1.88kg
ALL PJ-FFS200	500	220	1.92kg
ALL PJ-FFS300	500	320	2.11kg
ALL PJ-FFS400	500	420	2.40kg
ALL PJ-FFS450	500	470	2.49kg
ALL PJ-FFS500	500	520	2.57kg
ALL PJ-FFS600	500	620	2.72kg

Instruction Manual:

- ◆ Suitable for: supporting 100mm trays on floor, height adjustable
- ◆ Fit for: wire diameter from 3.5mm to 6.0 mm, tray width from 100mm to 600mm.
- ◆ Includes: bracket x1, pole x1 (bolt and nut optional).

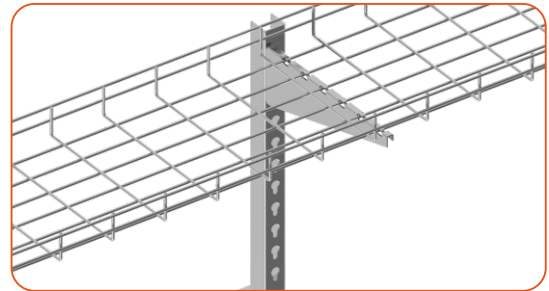
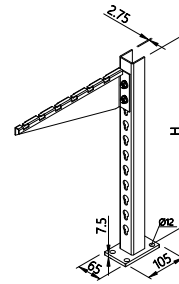

WALL MOUNT COUPLER v

Default unit: mm

Part Number	Height	Length	Weight
PJ-CDKK	43.4	40.6	0.07kg

Instruction Manual:

- ◆ Suitable for: fixing wire mesh cable trays to equipment.
- ◆ Fit for: wire diameter 4mm.

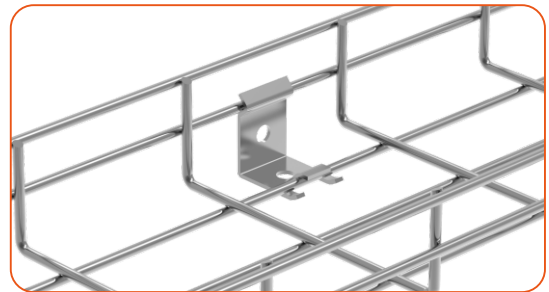
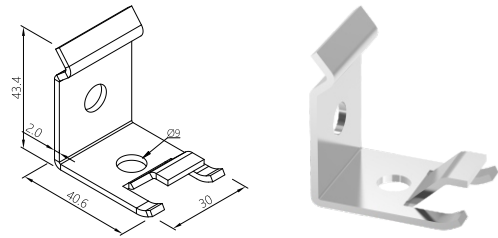

CENTRAL HOLD DOWN v

Default unit: mm

Part Number	Height	Length	Thickness	Pack	Weight
PJ-CHD	43	59	2.0	500	0.11kg

Instruction Manual:

- ◆ Suitable for: fixing trays on machinery or floor.
- ◆ Fit for: wire diameter from 4mm to 6mm.

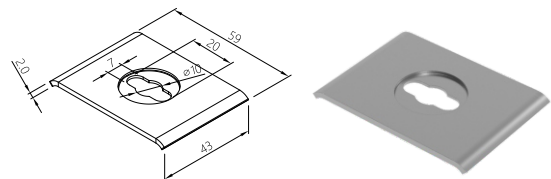

WIRE CLIP

Default unit: mm

Part Number	Width	Length	Thickness	Weight
ALL PJ-DSKK	16	22	2.5	0.03kg

Instruction Manual:

- ◆ Suitable for: mounting dividers or fixing wire mesh cable trays to mechanical equipment.
- ◆ Fit for: wire diameter from 4mm to 6mm.

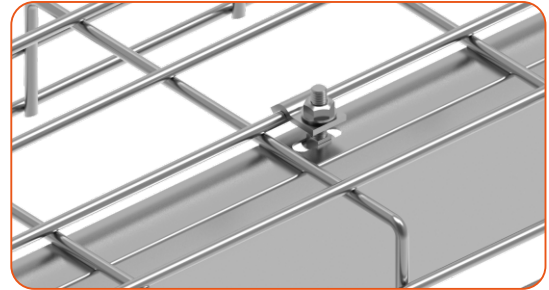
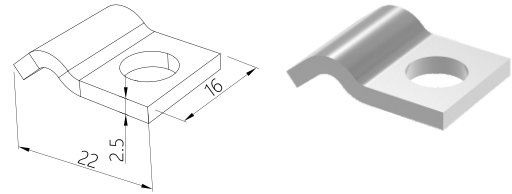

MOUNTING CLIP

Default unit: mm

Part Number	Width	Length	Thickness	Weight
EZ PJ-SHD	39	40	1.5	0.03kg

Instruction Manual:

- ◆ Suitable for: fixing wire mesh cable trays to mechanical equipment or floor directly.
- ◆ Fit for: wire diameter from 4mm to 6mm.

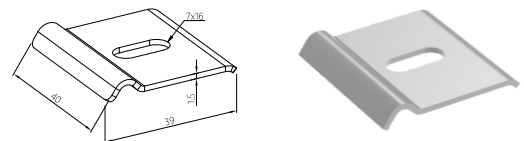

CROSS CLIP

Default unit: mm

Part Number	Width	Length	Weight
PJ-CCP	37	42	0.02kg

Instruction Manual:

- ◆ Suitable for: fixing wire mesh cable tray to mechanical equipment, wall or floor directly.
- ◆ Fit for: wire diameter from 4mm to 6mm.

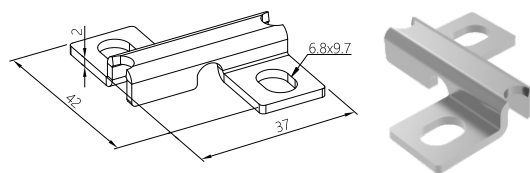

Notes



NINGBO VICHNET TECHNOLOGY CO., LTD



Tel: +36 1 611 7149

Fax: +36 1 455 0965

Website: www.powerbelt.hu

Email: linearisegyseg@powerbelt.hu

Headquarters Address:

- ♦ All rights reserved.
- ♦ Specifications and designs are subject to change without notice.